

School Furniture Specifications

Technical Drawings and Manufacturing Notes

dennis



basic education

Department:
Basic Education
REPUBLIC OF SOUTH AFRICA

Table of Contents

Contents

| | |
|--|----|
| Table of Contents..... | 2 |
| DOUBLE COMBINATION PRIMARY DESK GRADE 4-6 | 4 |
| SINGLE COMBINATION PRIMARY DESK GRADE 4-6 | 5 |
| DOUBLE COMBINATION PRIMARY DESK GRADE 1-3 | 6 |
| SINGLE COMBINATION PRIMARY DESK GRADE 1-3 | 7 |
| SINGLE COMBINATION SECONDARY DESK GRADE 7-12 | 8 |
| DOUBLE COMBINATION SECONDARY DESK GRADE 7-12 | 9 |
| DOUBLE PRIMARY STACKABLE TABLE GRADE 4-6 | 10 |
| SINGLE PRIMARY STACKABLE TABLE GRADE 1-3 | 11 |
| DOUBLE PRIMARY STACKABLE TABLE GRADE 1-3 | 12 |
| SINGLE SECONDARY STACKABLE TABLE GRADE 7-12 | 13 |
| DOUBLE SECONDARY STACKABLE TABLE GRADE 7-12 | 14 |
| SINGLE SECONDARY STACKABLE TABLE GRADE 4-6 | 15 |
| STACKABLE KINDERGARTEN TABLE GRADE R | 16 |
| CHAIR DINING AND SCHOOL HALL..... | 17 |
| CHAIR GRADE R | 18 |
| CHAIR GRADE 1-3 | 19 |
| CHAIR GRADE 4-6 | 20 |
| CHAIR LAB GRADE 7-12..... | 21 |
| CHAIR LAB GRADE 4-6..... | 22 |

| | |
|---|----|
| STUDENT TYPIST CHAIR W/O WHEELS GRADE 7-12 | 23 |
| STUDENT TYPIST CHAIR W/O WHEELS GRADE 4-6 | 24 |
| TEACHER’S CHAIR..... | 25 |
| TEACHER’S OFFICE/STAFF ROOM DESK | 26 |
| TEACHER’S CLASSROOM DESK | 27 |
| STATIONERY CUPBOARD 2- DOOR/S - SHELVES | 28 |
| STATIONERY CUPBOARD 2- DOOR/S - SHELVES | 29 |
| STEEL FRAME SINGLE BED..... | 30 |
| PRINCIPAL CHAIR HIGH BACK..... | 31 |
| ADMINISTRATOR CHAIR TYPIST | 32 |
| FILLING RACK PIGEON HOLE 30 DIVISION..... | 33 |
| PRINCIPAL CORRESPONDENCE RACK..... | 34 |
| PRINCIPAL GLASS BOOCKASE..... | 35 |
| LIBRARY BOOKSHELF..... | 36 |
| CORNER PIECE..... | 37 |
| PRINCIPAL DESK | 38 |
| FILLING CABINET PRINCIPAL | 39 |
| CREDENZA SLIDING DOORS – PRINCIPAL CREDENZA | 40 |
| UPHOLSTERED CHAIR – HEAD OF DEPT | 41 |
| UPHOLSTERED SICK ROOM CHAIR | 42 |

DOUBLE COMBINATION PRIMARY DESK GRADE 4-6

Note:

1. TOP FRONT SLAT, BACK, SLAT MANUFACTURED FROM 21MM SOLID SALIGNA, HARDWOOD (Eucalyptus Grandls)
2. MAIN STEEL FRAME Ø31.7X.6MM TUBING
3. SEAT SUPPORT RAIL Ø15.05X1.2MM TUBING
4. SEAT Ø15.88X1.2MM TUBING
5. COMPLETE STEEL FRAME BAKED LIGHT GREY EPOXY/POLYESTER POWDER COATING FINISH
6. DURABLE PLUGS FITTED ON ALL OPEN ENDS
7. ALL TIMBER COMPONENT TO BE VARNISHED WITH TWO COATS OF ACID CATALYSED LADOUER
8. FIT ALL TIMBER COMPONENTS TO STEEL FRAME WITH APPROVED M5/M5 BOLTS AND MYLOCK NUTS
9. DESK MUST COMPLY WITH SANS 880:2004 (Edition 3.2)

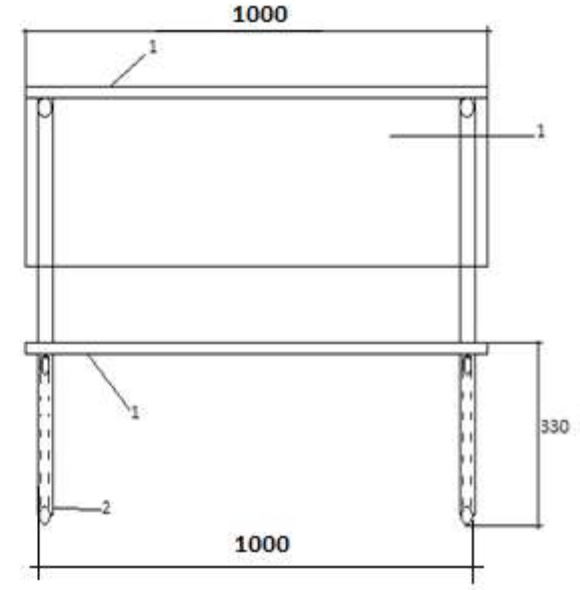
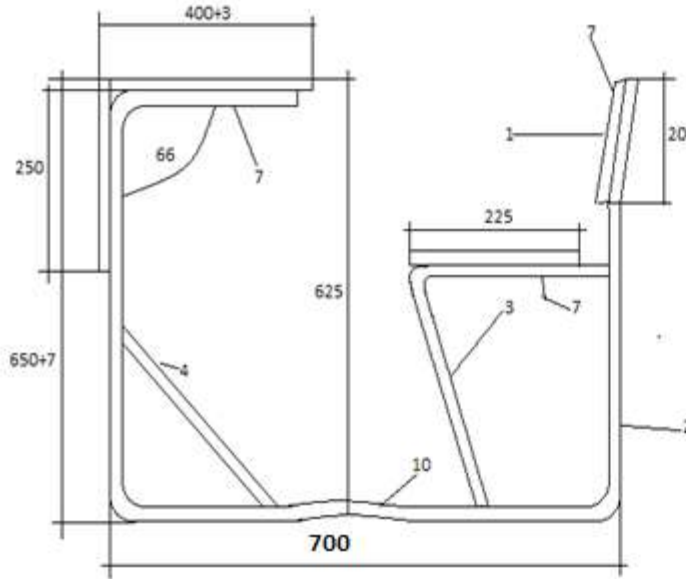



| ISSUE | DATE | CHANGE | SPECIFIED TOLERANCES | | | |
|-------|------|--------|---|---|--|--|
| | | |  | GRADE 4-6 | DOUBLE COMBINATION PRIMARY DESK | |
| | | | | X NO MEASUREMENTS TO BE SCALED FROM THE DRAWING | | |
| | | | | | | |
| | | | | | | |

SINGLE COMBINATION PRIMARY DESK GRADE 4-6

Note:

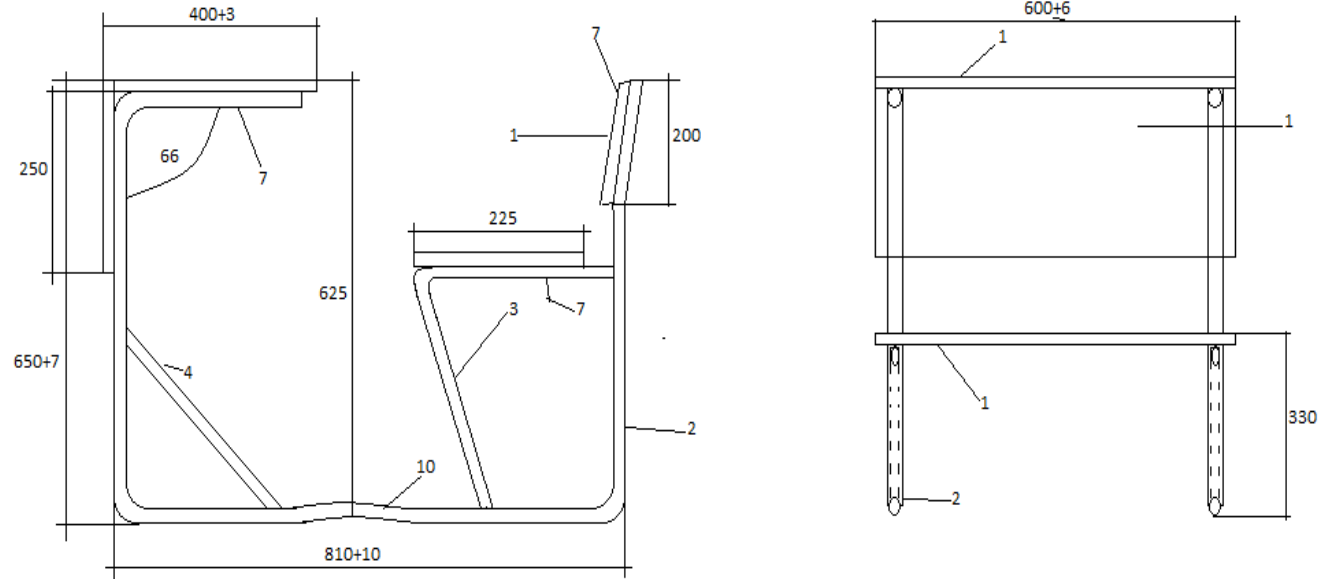
1. TOP FRONT SLAT, BACK, SLAT MANUFACTURED FROM 21MM SOLID SALIGNA, HARDWOOD (Eucalyptus Grandls)
2. MAIN STEEL FRAME Ø31.7X.6MM TUBING
3. SEAT SUPPORT RAIL Ø15.05X1.2MM TUBING
4. SEAT Ø15.88X1.2MM TUBING COMPLETE STEEL FRAME BAKED LIGHT GREY EPOXY/POLYESTER POWDER COATING FINISH
5. DURABLE PLUGS FITTED ON ALL OPEN ENDS
6. ALL TIMBER COMPONENT TO BE VARNISHED WITH TWO COATS OF ACID CATALYSED LADOUER
7. FIT ALL TIMBER COMPONENTS TO STEEL FRAME WITH APPROVED M5/M5 BOLTS AND MYLOCK NUTS
8. DESK MUST COMPLY WITH SANS 880:2004 (Edition 3.2)





| ISSUE | DATE | CHANGE | SPECIFIED TOLERANCES | GRADE 4-6 | SINGLE COMBINATION PRIMARY DESK | |
|-------|------|--------|--|------------------|--|--|
| | | |  | | | X NO MEASUREMENTS TO BE SCALED FROM THE DRAWING |

DOUBLE COMBINATION PRIMARY DESK GRADE 1-3

Note:

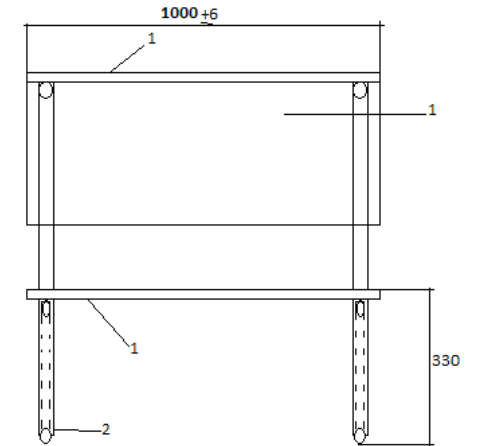
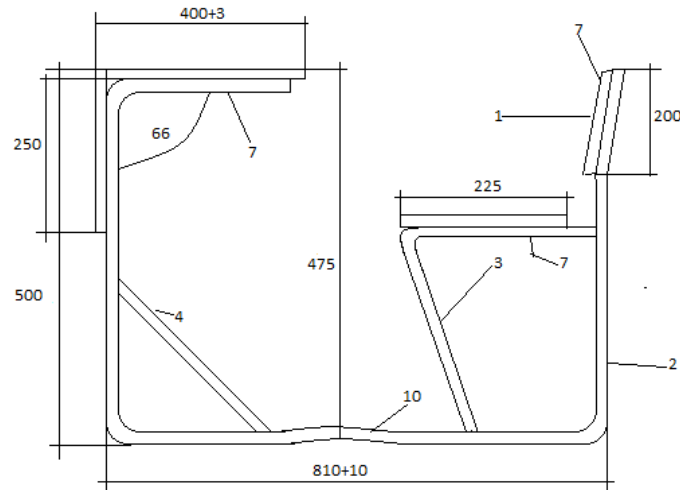
1. TOP FRONT SLAT, BACK, SLAT MANUFACTURED FROM 21MM SOLID SALIGNA, HARDWOOD (Eucalyptus Grandls)
2. MAIN STEEL FRAME Ø31.7X.6MM TUBING
3. SEAT SUPPORT RAIL Ø15.05X1.2MM TUBING
4. SEAT Ø15.88X1.2MM TUBING COMPLETE STEEL FRAME BAKED LIGHT GREY EPOXY/POLYESTER POWDER COATING FINISH
5. DURABLE PLUGS FITTED ON ALL OPEN ENDS
6. ALL TIMBER COMPONENT TO BE VARNISHED WITH TWO COATS OF ACID CATALYSED LADOUER
7. FIT ALL TIMBER COMPONENTS TO STEEL FRAME WITH APPROVED M5/M5 BOLTS AND MYLOCK NUTS
8. DESK MUST COMPLY WITH SANS 880:2004 (Edition 3.2)





| ISSUE | DATE | CHANGE | SPECIFIED TOLERANCES | GRADE 1-3 | DOUBLE COMBINATION PRIMARY DESK | |
|-------|------|--------|--|---|---------------------------------|--|
| | | |  | X NO MEASUREMENTS TO BE SCALED FROM THE DRAWING | | |
| | | | | | | |
| | | | | | | |
| | | | | | | |

SINGLE COMBINATION PRIMARY DESK GRADE 1-3

Note:

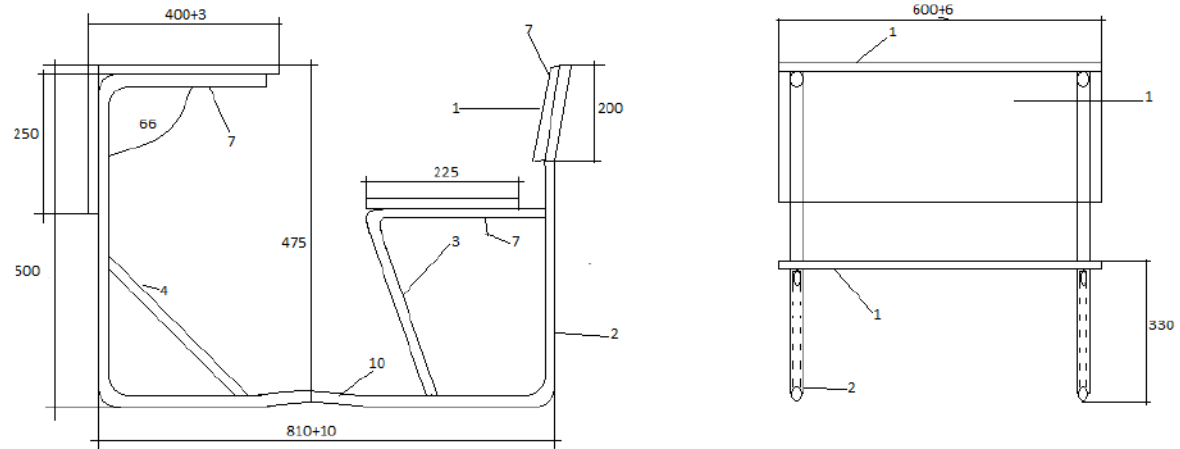
1. TOP FRONT SLAT, BACK, SLAT MANUFACTURED FROM 21MM SOLID SALIGNA, HARDWOOD (Eucalyptus Grandls)
2. MAIN STEEL FRAME Ø31.7X.6MM TUBING
3. SEAT SUPPORT RAIL Ø15.05X1.2MM TUBING
4. SEAT Ø15.88X1.2MM TUBING COMPLETE STEEL FRAME BAKED LIGHT GREY EPOXY/POLYESTER POWDER COATING FINISH
5. DURABLE PLUGS FITTED ON ALL OPEN ENDS
6. ALL TIMBER COMPONENT TO BE VARNISHED WITH TWO COATS OF ACID CATALYSED LADOUER
7. FIT ALL TIMBER COMPONENTS TO STEEL FRAME WITH APPROVED M5/M5 BOLTS AND MYLOCK NUTS
8. DESK MUST COMPLY WITH SANS 880:2004 (Edition 3.2)





| ISSUE | DATE | CHANGE | SPECIFIED TOLERANCES | | | |
|-------|------|--------|---|--|--|--|
| | | |  | <p style="text-align: center;">GRADE 1-3</p> <p style="text-align: center;">X NO MEASUREMENTS TO BE SCALED FROM THE DRAWING</p> | <p style="text-align: center;"><i>SINGLE COMBINATION PRIMARY DESK</i></p> | |

SINGLE COMBINATION SECONDARY DESK GRADE 7-12

Note:

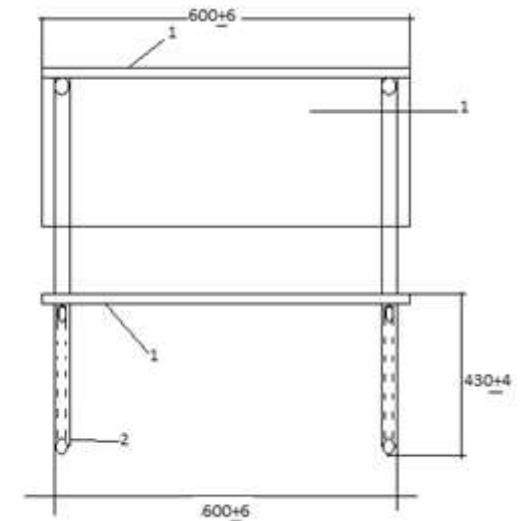
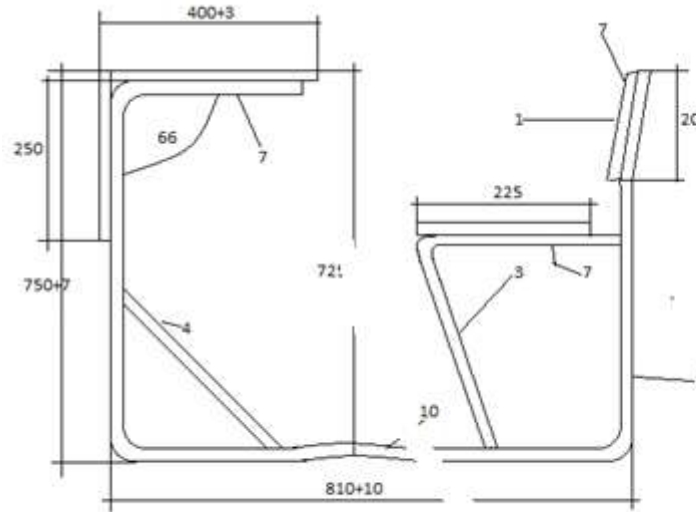
1. TOP FRONT SLAT, BACK, SLAT MANUFACTURED FROM 21MM SOLID SALIGNA, HARDWOOD (Eucalyptus Grandls)
2. MAIN STEEL FRAME Ø31.7X.6MM TUBING
3. SEAT SUPPORT RAIL Ø15.05X1.2MM TUBING
4. SEAT Ø15.88X1.2MM TUBING COMPLETE STEEL FRAME BAKED LIGHT GREY EPOXY/POLYESTER POWDER COATING FINISH
5. DURABLE PLUGS FITTED ON ALL OPEN ENDS
6. ALL TIMBER COMPONENT TO BE VARNISHED WITH TWO COATS OF ACID CATALYSED LADOUER
7. FIT ALL TIMBER COMPONENTS TO STEEL FRAME WITH APPROVED M5/M5 BOLTS AND MYLOCK NUTS
8. DESK MUST COMPLY WITH SANS 880:2004 (Edition 3.2)



| ISSUE | DATE | CHANGE | SPECIFIED TOLERANCES | <p align="center">GRADE 7-12</p> <p align="center">X NO MEASUREMENTS TO BE SCALED FROM THE DRAWING</p> | <p align="center">SINGLE COMBINATION SECONDARY DESK</p> | | | |
|-------|------|--------|--|---|--|--|--|--|
| | | |  | | | | | |
| | | | | | | | | |
| | | | | | | | | |
| | | | | | | | | |

DOUBLE COMBINATION SECONDARY DESK GRADE 7-12

Note:

1. TOP FRONT SLAT, BACK, SLAT MANUFACTURED FROM 21MM SOLID SALIGNA, HARDWOOD (Eucalyptus Grandls)
2. MAIN STEEL FRAME Ø31.7X.6MM TUBING
3. SEAT SUPPORT RAIL Ø15.05X1.2MM TUBING
4. SEAT Ø15.88X1.2MM TUBING COMPLETE STEEL FRAME BAKED LIGHT GREY EPOXY/POLYESTER POWDER COATING FINISH
5. DURABLE PLUGS FITTED ON ALL OPEN ENDS
6. ALL TIMBER COMPONENT TO BE VARNISHED WITH TWO COATS OF ACID CATALYSED LADOUER
7. FIT ALL TIMBER COMPONENTS TO STEEL FRAME WITH APPROVED M5/M5 BOLTS AND MYLOCK NUTS
8. DESK MUST COMPLY WITH SANS 880:2004 (Edition 3.2)

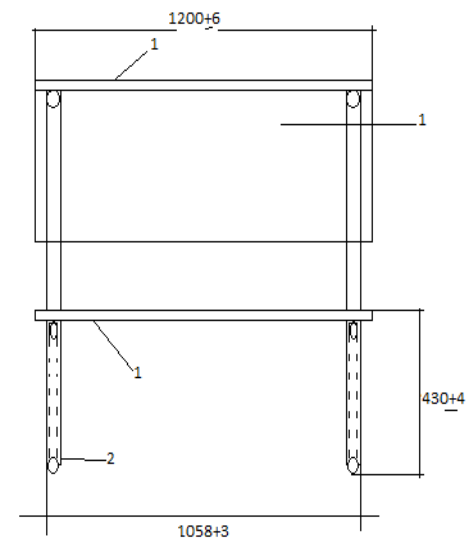
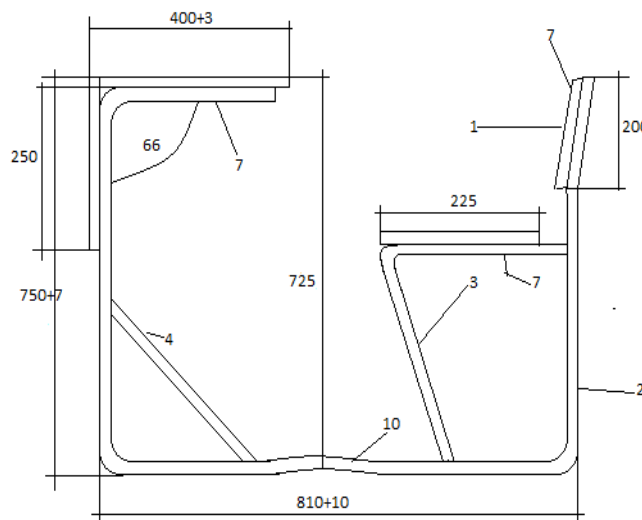

| ISSUE | DATE | CHANGE |  | <p style="text-align: center;">GRADE 7-12</p> <p style="text-align: center;">X NO MEASUREMENTS TO BE SCALED FROM THE DRAWING</p> | <p style="text-align: center;">DOUBLE COMBINATION SECONDARY DESK</p> | |
|-------|------|--------|--|---|---|--|
|-------|------|--------|--|---|---|--|

DOUBLE PRIMARY STACKABLE TABLE GRADE 4-6

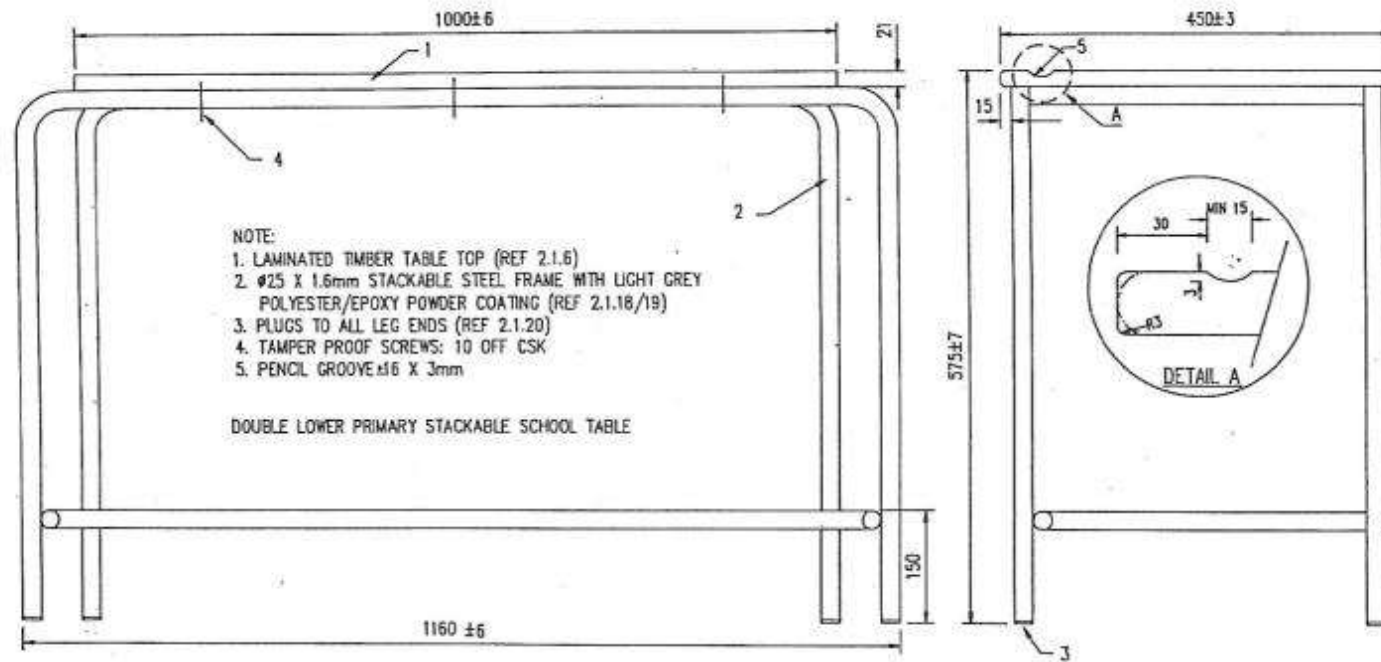



| ISSUE | DATE | CHANGE | SPECIFIED TOLERANCES | GRADE 4-6 | DOUBLE STACKABLE SCHOOL TABLE | |
|-------|------|--------|--|-----------|-------------------------------|---|
| | | |  | | | X NO MEASUREMENTS TO BE SCALED FROM THE DRAWING |

SINGLE PRIMARY STACKABLE TABLE GRADE 1-3

Note:

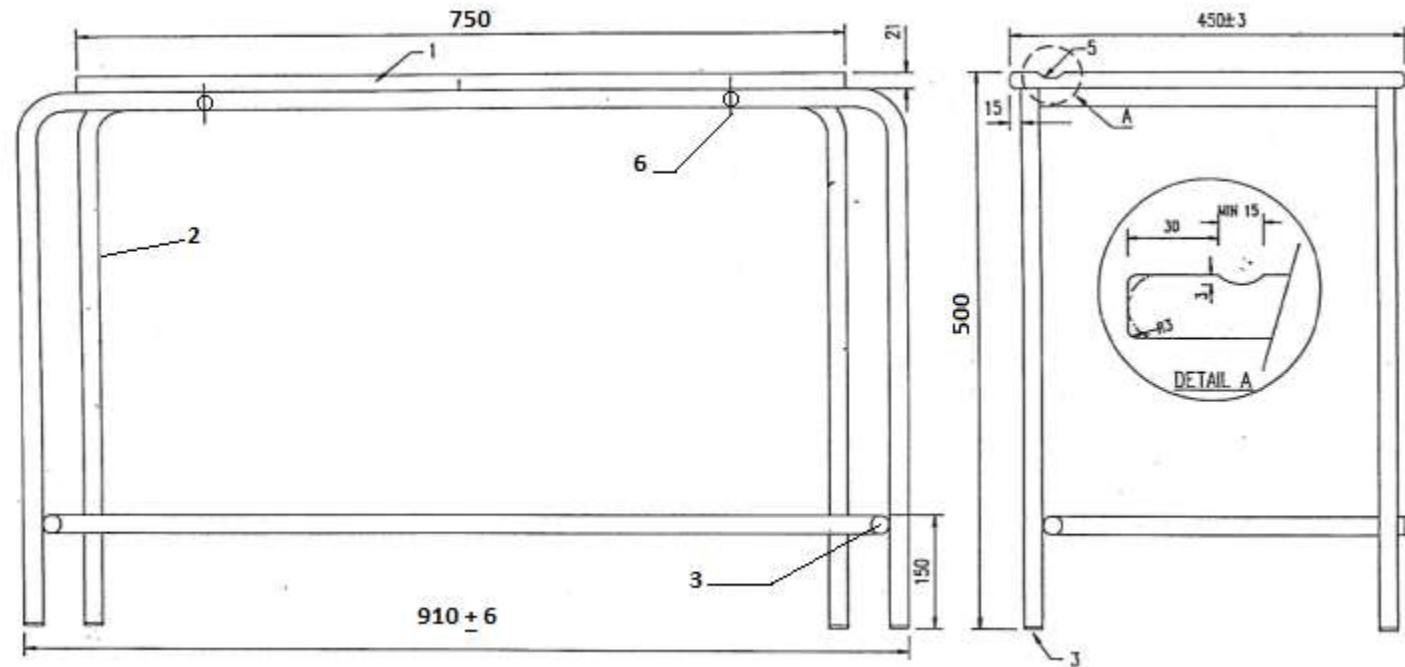
1. TABLE TOP – 21MM SOLID SALIGNA HARDWOOD (Eucalyptus Grandls)
2. Ø25X1.6mm TUBING STACKABLE STEEL FRAME WITH BAKED LIGHT GREY EPOXY/POLYESTER POWDER COATING FINISH
3. DURABLE PLUGS FITTED TO ALL OPEN ENDS
4. PENCIL GROOVE 16X3mm
5. ALL TIMBER COMPONENTS TO BE VARNISHED WITH TWO COATS OF ACID CATALYSED LACCUER
6. FIT TOP STEEL FRAME WITH APPROVED SCREWS
7. TABLE MUST COMPLY WITH SANS 660:2004 (Edition 3.2)



| ISSUE | DATE | CHANGE | SPECIFIED TOLERANCES | GRADE 1-3 | SINGLE STACKABLE SCHOOL TABLE |
|-------|------|--------|--|---|-------------------------------|
| | | |  | X NO MEASUREMENTS TO BE SCALED FROM THE DRAWING | |
| | | | | | |
| | | | | | |
| | | | | | |

DOUBLE PRIMARY STACKABLE TABLE GRADE 1-3

Note:

1. SOLID SALIGNA HARDWOOD TABLE TOP
2. Ø25X1.6mm STACKABLE STEEL FRAME WITH LIGHT GREY POLYESTER/EPOXY COATING.
3. PLASTIC STACKING BLOCK
4. NYLON FERRULES/PLUGS TO ALL STEEL OPEN ENDS
5. "ONE WAY" GALV SCREWS: 6XOFF NO. 10X40
4XOFF NO 10X45
PENCIL GROOVE 16X3mm

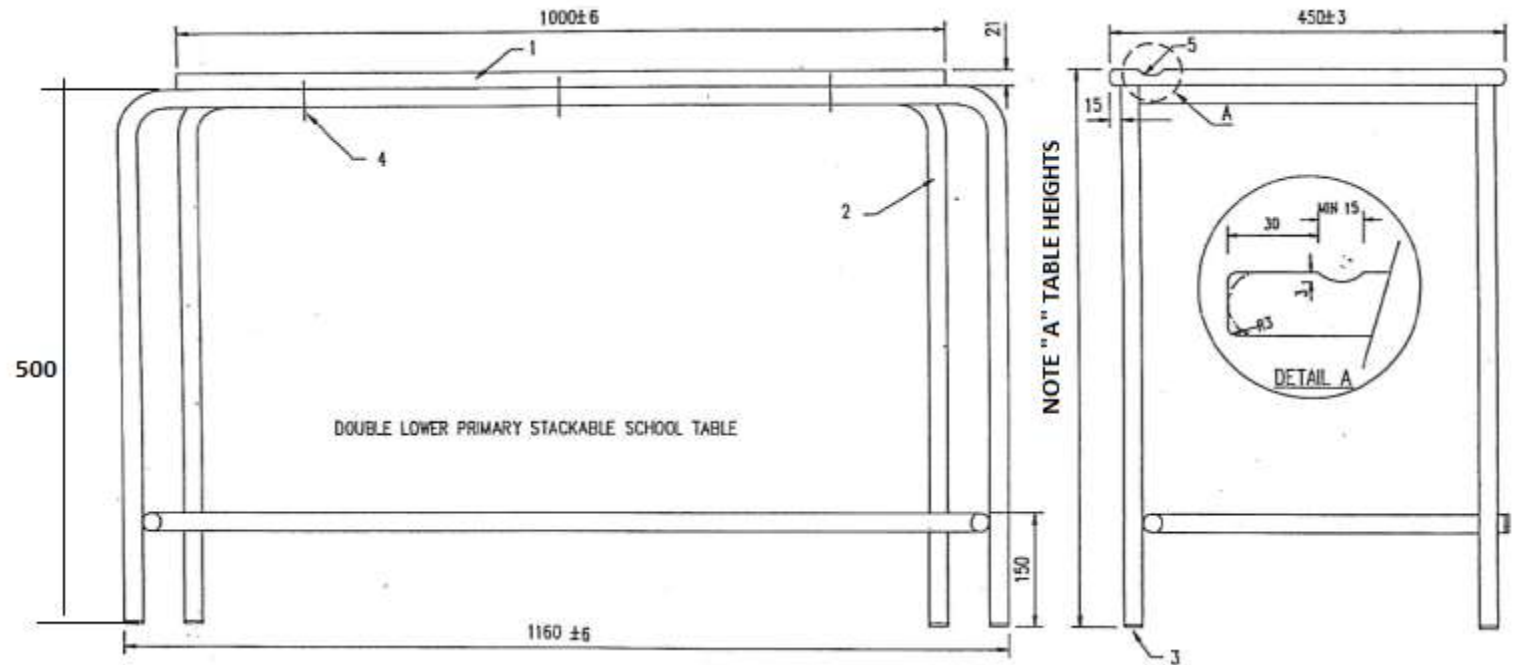

NOTE "A" :TABLE HEIGHTS (TOL ± 7) – Put the height on the drawing
NO.2 TABLE: 500mm H

| ISSUE | DATE | CHANGE | SPECIFIED TOLERANCES | GRADE 1-3 | DOUBLE STACKABLE SCHOOL TABLE |
|-------|------|--------|---|---|-------------------------------|
| | | |  | X NO MEASUREMENTS TO BE SCALED FROM THE DRAWING | |
| | | | | | |
| | | | | | |
| | | | | | |

SINGLE SECONDARY STACKABLE TABLE GRADE 7-12

Note:

1. TABLE TOP – 21MM SOLID SALIGNA HARDWOOD (Eucalyptus Grendles)
2. Ø 25X1.6MM TUBING STACKABLE STEEL FRAME WITH BAKED LIGHT GREY EPOXY/POLYESTER POWDER COATING FINISH
3. DURABLE PLUGS FITTED TO ALL OPEN ENDS
4. PENCIL GROOVE 16X3MM
5. ALL TIMBER COMPONENTS TO BE VARNISHED WITH TWO COATS OF ACID CATALYSED LACCUER
6. FIT TOOP STEEL FRAME WITH APPROACHED SCREWS
7. TABLE MUST COMPLY WITH SANS 660:2004 (Edition 3.2)

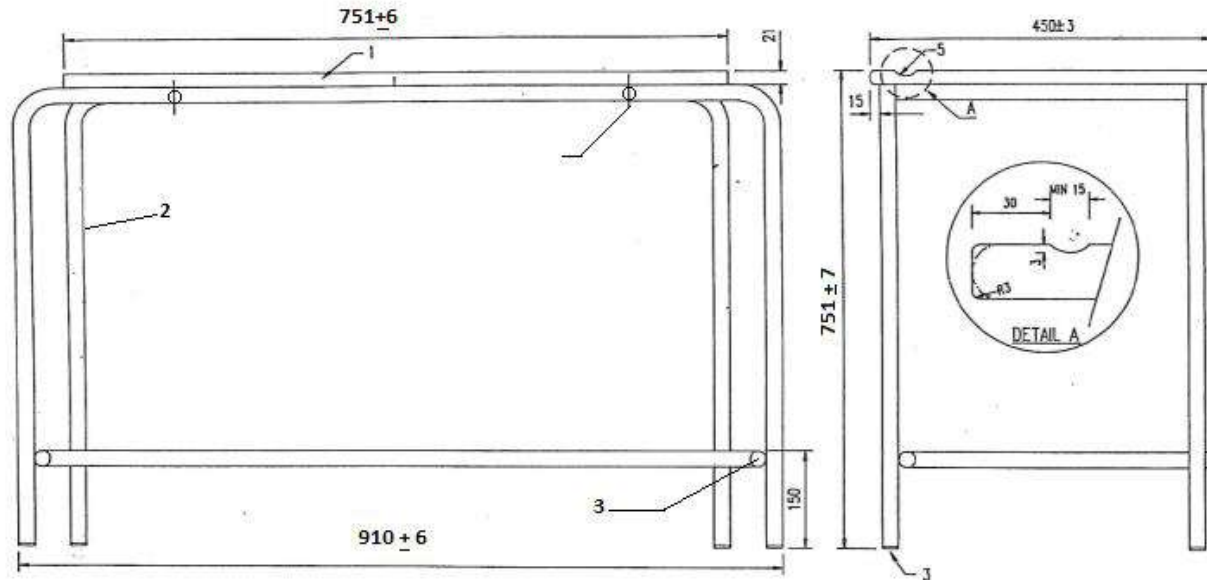



| ISSUE | DATE | CHANGE | SPECIFIED TOLERANCES | <p style="text-align: center;">GRADE 7-12</p> <p style="text-align: center;"><i>SINGLE STACKABLE SECONDARY SCHOOL TABLE</i></p> <p>X NO MEASUREMENTS TO BE SCALED FROM THE DRAWING</p> | |
|-------|------|--------|--|---|--|
| | | |  | | |
| | | | | | |
| | | | | | |
| | | | | | |

DOUBLE SECONDARY STACKABLE TABLE GRADE 7-12

Note:

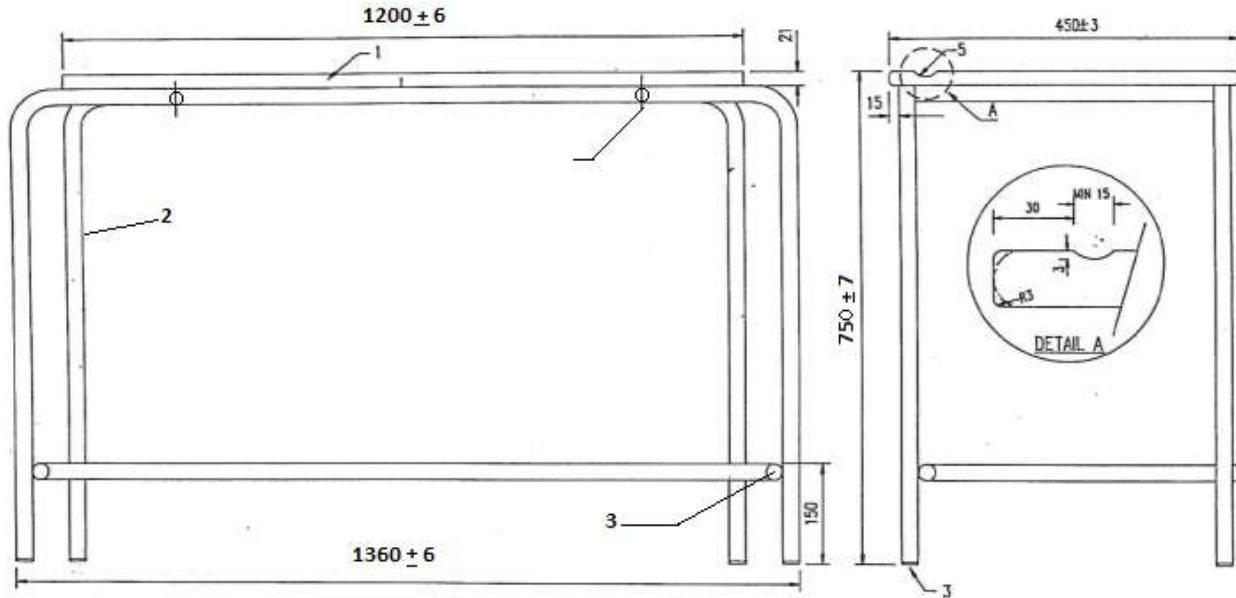
1. LAMINATED TIMBER TABLE TOP (REF 2.1.6)
2. Ø 25X1.6mm STEEL TUBING, STACKABLE WITH BAKED POLYESTER/EPOXY POWDER COATING (REF 2.1.18/19)
3. PLUGS TO ALL LEG ENDS (REF 2.1.20)
4. TAMPER PROOF SCREWS (10 OFF CSK)





| ISSUE | DATE | CHANGE | SPECIFIED TOLERANCES | <p>GRADE 7-12</p> <p>X NO MEASUREMENTS TO BE SCALED FROM THE DRAWING</p> | <p>DOUBLE STACKABLE SECONDARY SCHOOL TABLE</p> | |
|-------|------|--------|--|---|---|--|
| | | |  | | | |
| | | | | | | |
| | | | | | | |
| | | | | | | |

SINGLE SECONDARY STACKABLE TABLE GRADE 4-6

Note:

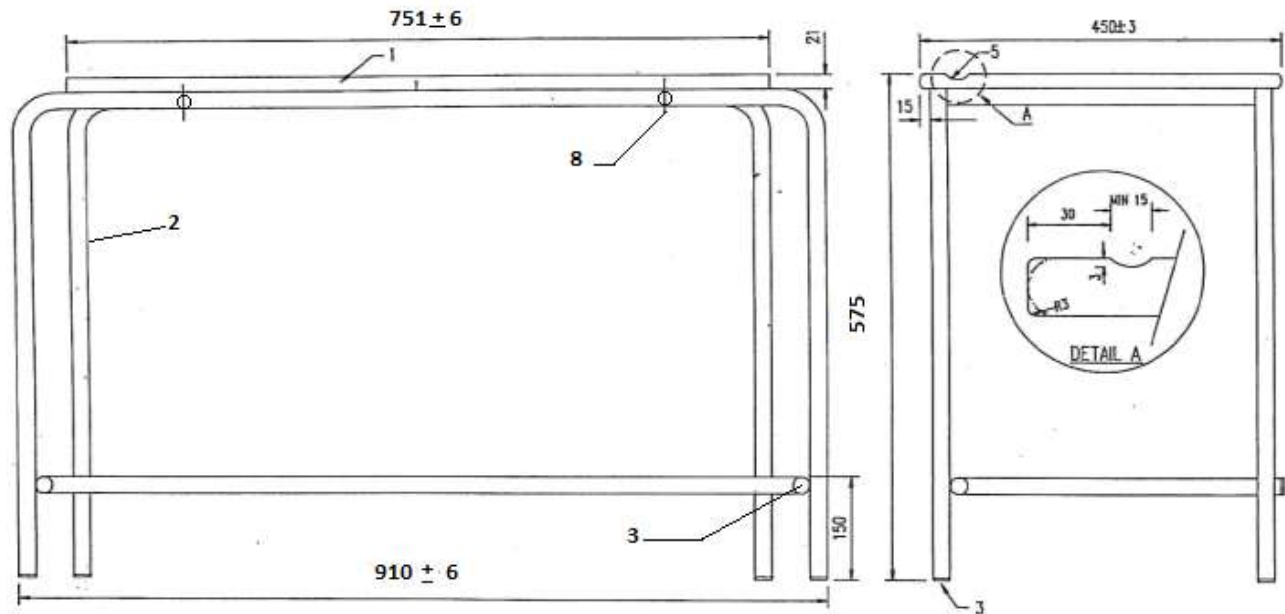
1. TABLE TOP – 21MM SOLID SALIGNA HARDWOOD (Eucalyptus Grendles)
2. Ø 25X1.6MM TUBING STACKABLE STEEL FRAME WITH BAKED LIGHT GREY EPOXY/POLYESTER POWDER COATING FINISH
3. DURABLE PLUGS FITTED TO ALL OPEN ENDS
4. PENCIL GROOVE 16X3MM
5. ALL TIMBER COMPONENTS TO BE VARNISHED WITH TWO COATS OF ACID CATALYSED LACCUER
6. FIT TOOP STEEL FRAME WITH APPROACHED SCREWS
7. TABLE MUST COMPLY WITH SANS 660:2004 (Edition 3.2)





| ISSUE | DATE | CHANGE | SPECIFIED TOLERANCES | GRADE 4 - 6 | SINGLE STACKABLE SECONDARY SCHOOL TABLE |
|-------|------|--------|--|---|---|
| | | |  | X NO MEASUREMENTS TO BE SCALED FROM THE DRAWING | |
| | | | | | |
| | | | | | |
| | | | | | |

STACKABLE KINDERGARTEN TABLE GRADE R

Note:

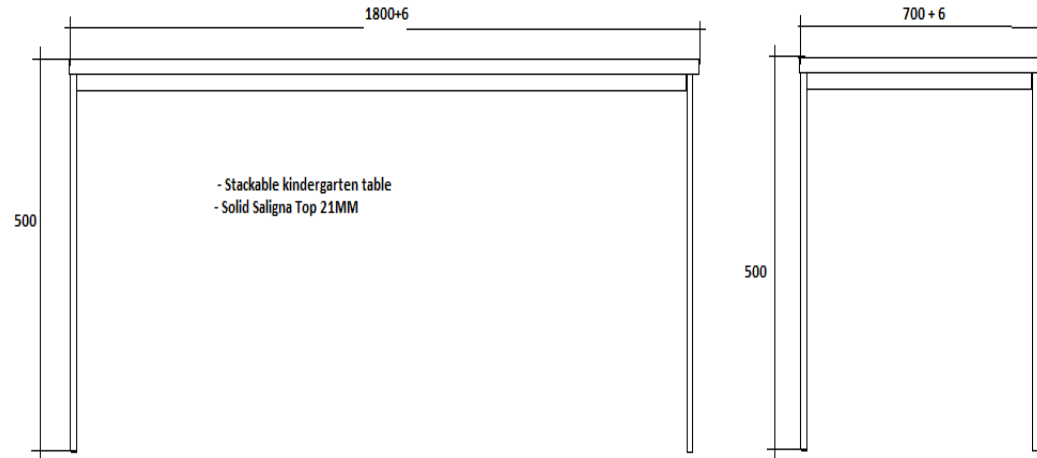
1. TABLE TOP – 21MM SOLID SALIGNA HARDWOOD (Eucalyptus Grendles)
2. Ø 25X1.6MM TUBING STACKABLE STEEL FRAME WITH BAKED LIGHT GREY EPOXY/POLYESTER POWDER COATING FINISH
3. DURABLE PLUGS FITTED TO ALL OPEN ENDS
4. PENCIL GROOVE 16X3MM
5. ALL TIMBER COMPONENTS TO BE VARNISHED WITH TWO COATS OF ACID CATALYSED LACCUER
6. FIT TOOP STEEL FRAME WITH APPROACHED SCREWS
7. TABLE MUST COMPLY WITH SANS 660:2004 (Edition 3.2)





| ISSUE | DATE | CHANGE | SPECIFIED TOLERANCES | GRADE R | EIGHT SEATER KINDEGARTEN TABLE |
|-------|------|---|----------------------|--|--|
| | |  | | <p>GRADE R</p> <p>X NO MEASUREMENTS TO BE SCALED FROM THE DRAWING</p> | <p>EIGHT SEATER KINDEGARTEN TABLE</p> |
| | | | | | |
| | | | | | |
| | | | | | |

CHAIR DINING AND SCHOOL HALL

Note:

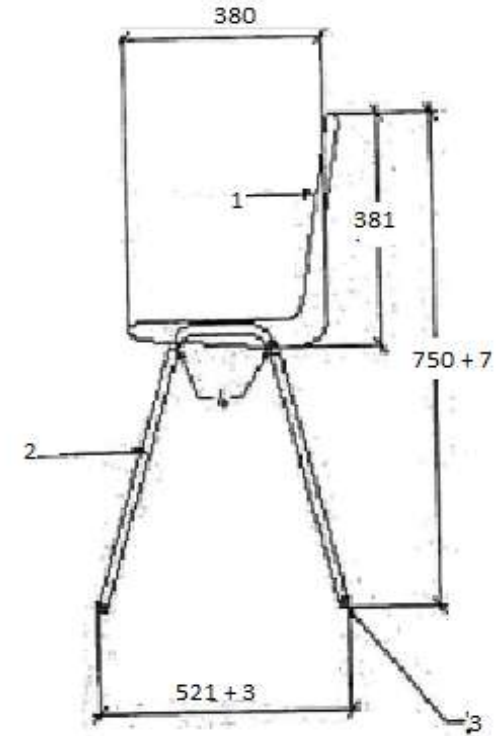
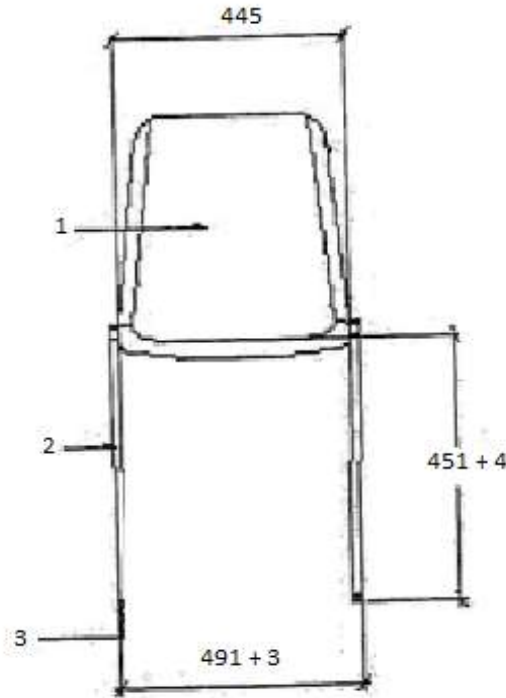
1. SEAT INJECTION MOULDED POLYPROPYLENE COPOLYMER
2. STACKABLE STEEL FRAME Ø 19.05X1.6MM TUBING WITH BAKED LIGHT GREY EPOXY/POLYESTER POWDER COATING FINISH
3. DURABLE FERRULES FITTED TO ALL LEG ENDS
4. FIT SEAT TO STEEL FRAME WITH APPROVED SCREWS.
5. CHAIR MUST COMPLY WITH SANS 660:2004 (Edition 3.2)





| ISSUE | DATE | CHANGE | SPECIFIED TOLERANCES | <p align="center">DINING AND SCHOOL HALL GRADE 7-12</p> <p align="center">X NO MEASUREMENTS TO BE SCALED FROM THE DRAWING</p> | <p align="center">LARGE SECONDARY STACKABLE SCHOOL CHAIR</p> | | | |
|-------|------|---|---|--|---|--|--|--|
| | |  | <p>"FIGURE" = +/- 1.2 "FIGURE" = +/- 1.5 "FIGURE" = +/- 1.1</p> <p>UNSPECIFIED TOLERANCES = +/- 2.1</p> | | | | | |
| | | | | | | | | |
| | | | | | | | | |
| | | | | | | | | |

CHAIR GRADE R

Note:

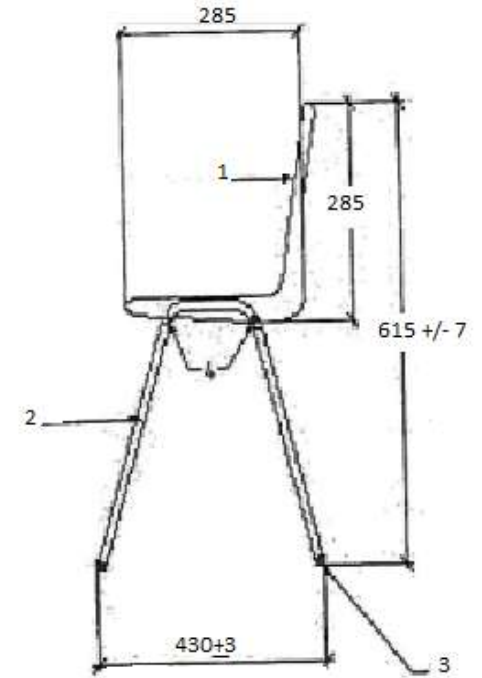
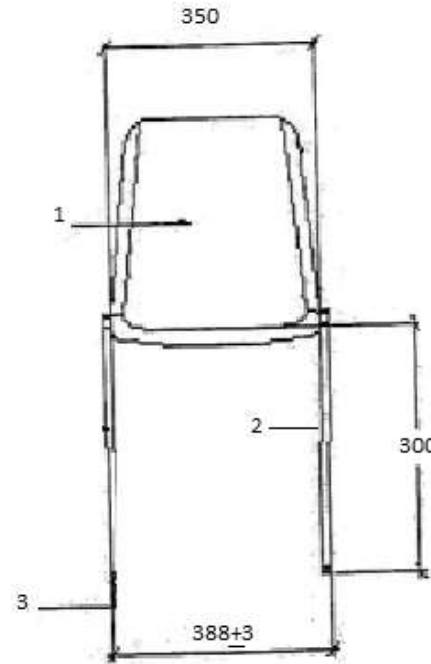
1. SEAT INJECTION MOULDED POLYPROPYLENE COPOLYMER
2. STACKABLE STEEL FRAME Ø 19.05X1.6MM TUBING WITH BAKED LIGHT GREY EPOXY/POLYESTER POWDER COATING FINISH
3. DURABLE FERRULES FITTED TO ALL LEG ENDS
4. FIT SEAT TO STEEL FRAME WITH APPROVED SCREWS.
5. CHAIR MUST COMPLY WITH SANS 660:2004 (Edition 3.2)





| ISSUE | DATE | CHANGE | SPECIFIED TOLERANCES | GRADE R | LOWER PRIMARY STACKABLE SCHOOL CHAIR |
|-------|------|---|--|---|--------------------------------------|
| | |  | "FIGURE" =+/- 1.2 "FIGURE" =+/- 1.5 "FIGURE" =+/- 1.1 UNSPECIFIED TOLERANCES =+/- 2.1 | X NO MEASUREMENTS TO BE SCALED FROM THE DRAWING | |
| | | | | | |
| | | | | | |
| | | | | | |

CHAIR GRADE 1-3

Note:

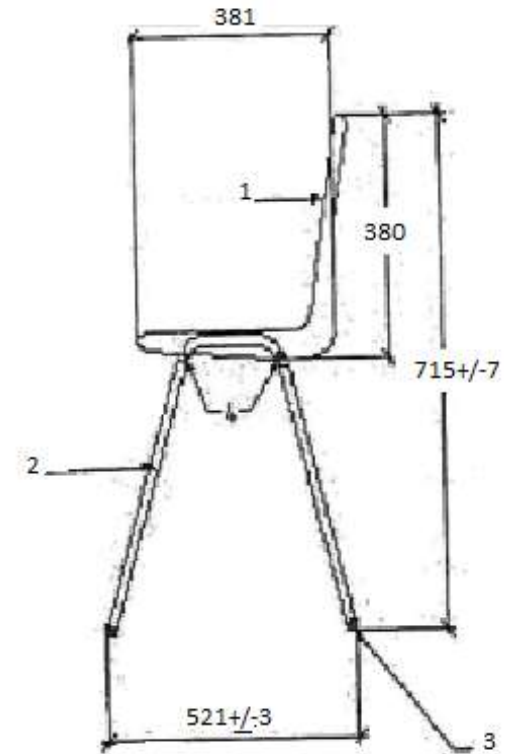
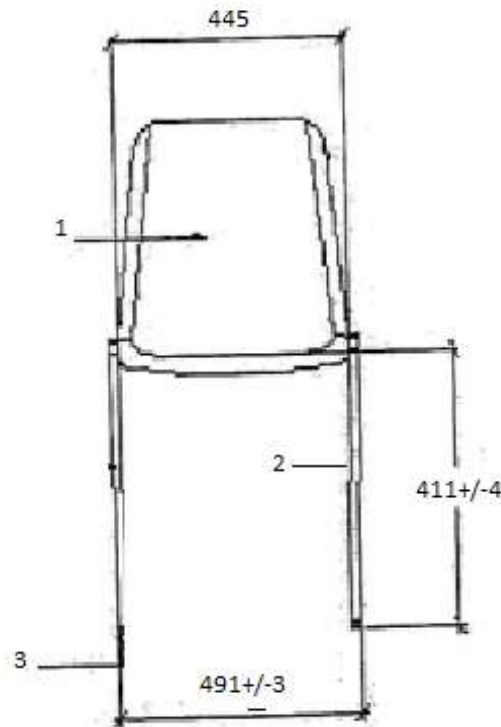
1. SEAT INJECTION MOULDED POLYPROPYLENE COPOLYMER
2. STACKABLE STEEL FRAME Ø 19.05X1.6MM TUBING WITH BAKED LIGHT GREY EPOXY/POLYESTER POWDER COATING FINISH
3. DURABLE FERRULES FITTED TO ALL LEG ENDS
4. FIT SEAT TO STEEL FRAME WITH APPROVED SCREWS.
5. CHAIR MUST COMPLY WITH SANS 660:2004 (Edition 3.2)





| ISSUE | DATE | CHANGE | SPECIFIED TOLERANCES | GRADE 1-3 X NO MEASUREMENTS TO BE SCALED FROM THE DRAWING | LOWER PRIMARY STACKABLE SCHOOL CHAIR | | |
|-------|------|---|--|--|--|--|--|
| | |  | "FIGURE" = +/- 1.2 "FIGURE" = +/- 1.5 "FIGURE" = +/- 1.1 UNSPECIFIED TOLERANCES = +/- 2.1 | | | | |
| | | | | | | | |
| | | | | | | | |
| | | | | | | | |

CHAIR GRADE 4-6

Note:

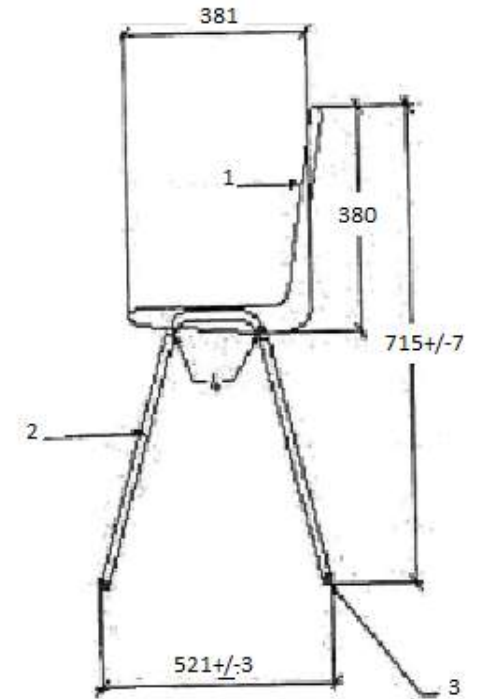
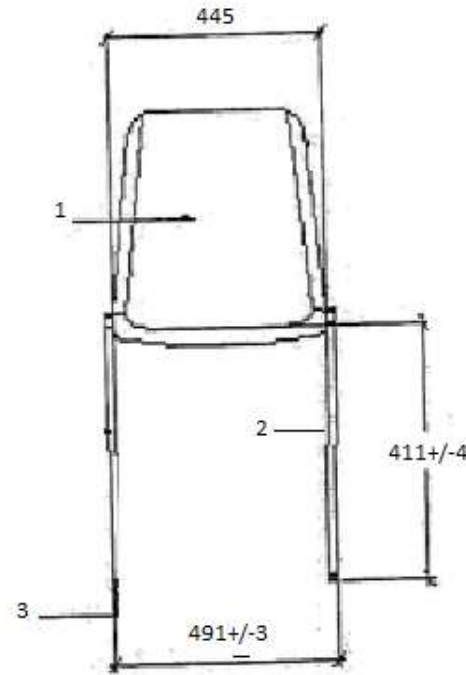
1. SEAT INJECTION MOULDED POLYPROPYLENE COPOLYMER
2. STACKABLE STEEL FRAME Ø 19.05X1.6MM TUBING WITH BAKED LIGHT GREY EPOXY/POLYESTER POWDER COATING FINISH
3. DURABLE FERRULES FITTED TO ALL LEG ENDS
4. FIT SEAT TO STEEL FRAME WITH APPROVED SCREWS.
5. CHAIR MUST COMPLY WITH SANS 660:2004 (Edition 3.2)





| ISSUE | DATE | CHANGE | SPECIFIED TOLERANCES | GRADE 4-6 | HIGHER PRIMARY STACKABLE SCHOOL CHAIR |
|-------|------|---|--|---|---------------------------------------|
| | |  | "FIGURE" = +/- 1.2 "FIGURE" = +/- 1.5 "FIGURE" = +/- 1.1 UNSPECIFIED TOLERANCES = +/- 2.1 | X NO MEASUREMENTS TO BE SCALED FROM THE DRAWING | |
| | | | | | |
| | | | | | |
| | | | | | |
| | | | | | |

CHAIR LAB GRADE 7-12

Note:

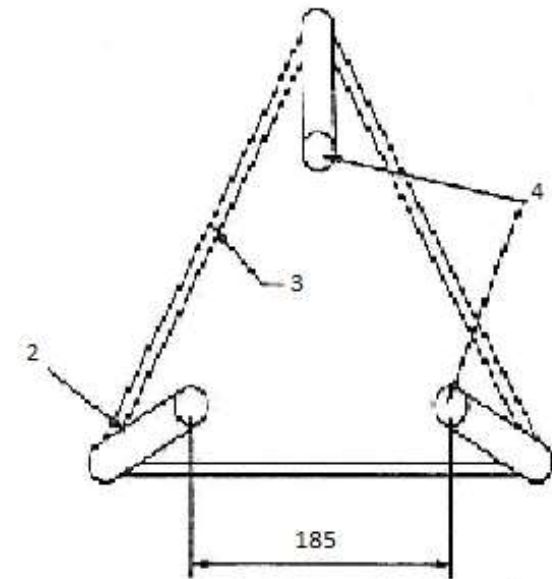
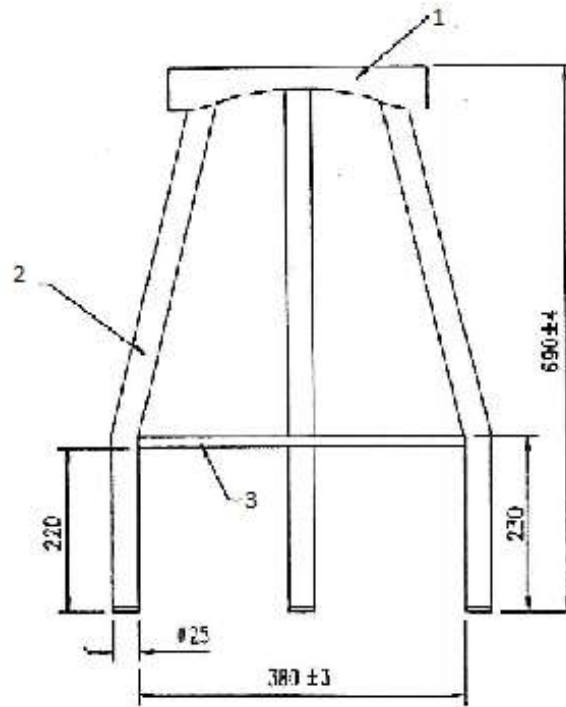
1. Ø300MM POLYPROPYLENE COPOLYMER INJECTION MOULDED SEAT TO BE FITTED BY MEANS OF POP RIVETS (REF 2.1.8)
2. Ø25X1.6MM STEEL TUBING WITH BAKED POLYESTER/EPOXY LIGHT GREY POWDER COATING (REF 2.1.18/19)
3. Ø10MM STEEL ROD
4. NYLON PLUGS TO ALL LEG ENDS (REF 2.1.20)





| ISSUE | DATE | CHANGE | SPECIFIED TOLERANCES | GRADE 7-12 | LAB CHAIR | |
|-------|------|--------|--|---|-------------------------|--|
| | | |  | <p>GRADE 7-12</p> <p>X NO MEASUREMENTS TO BE SCALED FROM THE DRAWING</p> | <p>LAB CHAIR</p> | |
| | | | | | | |
| | | | | | | |
| | | | | | | |

CHAIR LAB GRADE 4-6

Note:

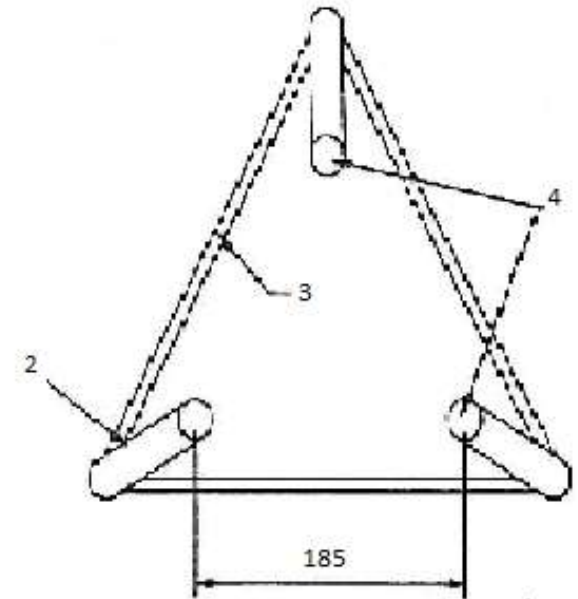
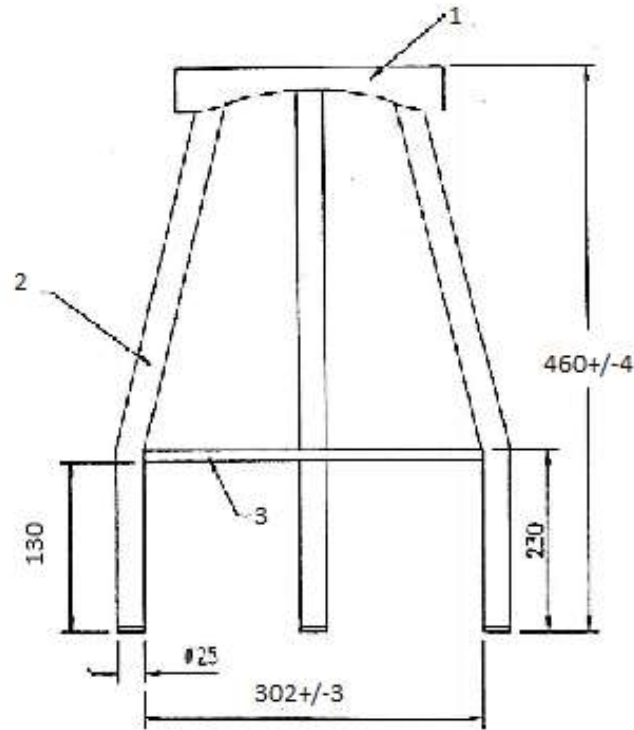
1. Ø300MM POLYPROPYLENE COPOLYMER INJECTION MOULDED SEAT TO BE FITTED BY MEANS OF POP RIVETS (REF 2.1.8)
2. Ø25X1.6MM STEEL TUBING WITH BAKED POLYESTER/EPOXY LIGHT GREY POWDER COATING (REF 2.1.18/19)
3. Ø10MM STEEL ROD
4. NYLON PLUGS TO ALL LEG ENDS (REF 2.1.20)





| ISSUE | DATE | CHANGE | SPECIFIED TOLERANCES | GRADE 4-6 | LAB CHAIR | |
|-------|------|--------|--|--|-----------|--|
| | | |  | <p>X NO MEASUREMENTS TO BE SCALED FROM THE DRAWING</p> | | |

STUDENT TYPIST CHAIR W/O WHEELS GRADE 7-12

Note:

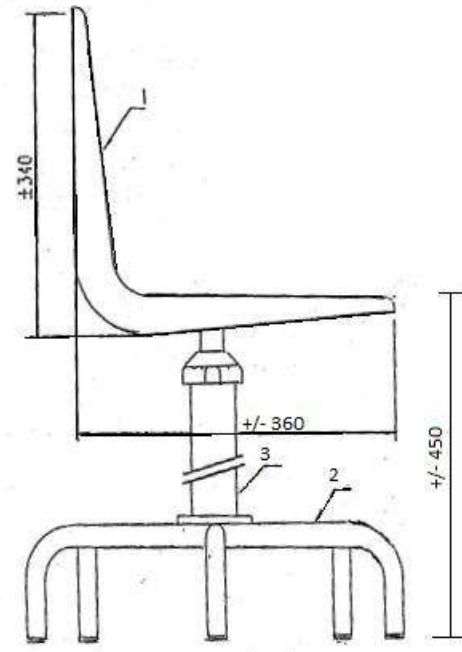
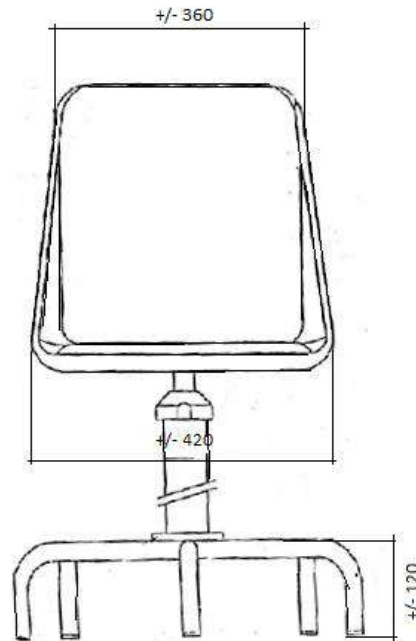
1. SEAT INJECTION MOULDED POLYPROPYLENE COPOLYMER (REF.2.1.8) ORANGE
2. STEEL FRAME: Ø 19X1.6mm WITH BAKED LIGHT GREY POLYESTER/EPOXY POWDER COATING (REF.2.1.18/19)
3. ADJUSTABLE BY MEANS OF A SPINDLE FITTED INTO A TAPERED BUSH
4. NYLON PLUGS TO ALLEG ENDS (REF.2.1.20)
5. SEAT FASTEN WITH TAMPERED PROOF SCREWS TO SEAT FRAME





| ISSUE | DATE | CHANGE | SPECIFIED TOLERANCES | <p align="center">STUDENT TYPIST CHAIR W/O WHEELS GRADE 7-12</p> <p align="center">X NO MEASUREMENTS TO BE SCALED FROM THE DRAWING</p> | <p align="center"><i>MOULDED POLYPROPYLENE, STEEL FRAME</i></p> | |
|-------|------|--------|--|---|--|--|
| | | |  | | | |

STUDENT TYPIST CHAIR W/O WHEELS GRADE 4-6

Note:

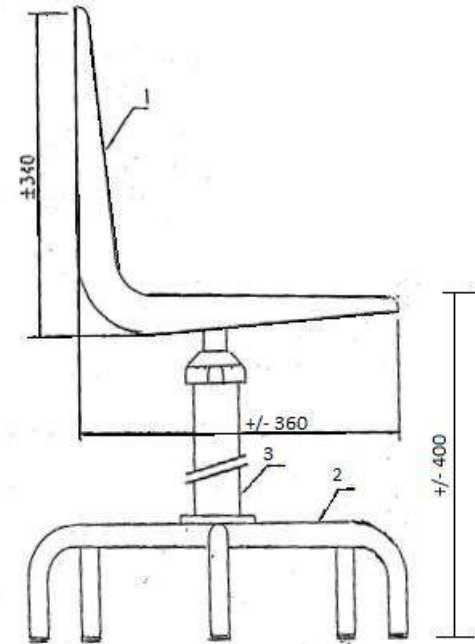
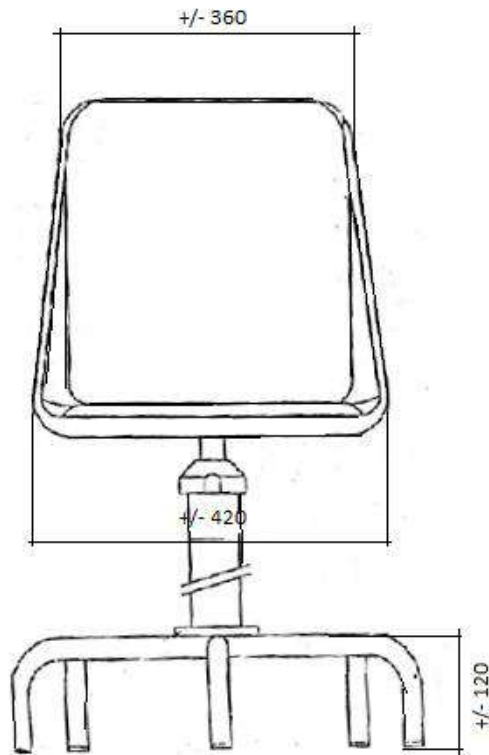
1. SEAT INJECTION MOULDED POLYPROPYLENE COPOLYMER (REF.2.1.8) ORANGE
2. STEEL FRAME: Ø 19X1.6mm WITH BAKED LIGHT GREY POLYESTER/EPOXY POWDER COATING (REF.2.1.18/19)
3. ADJUSTABLE BY MEANS OF A SPINDLE FITTED INTO A TAPERED BUSH
4. NYLON PLUGS TO ALLEG ENDS (REF.2.1.20)
5. SEAT FASTEN WITH TAMPERED PROOF SCREWS TO SEAT FRAME



| ISSUE | DATE | CHANGE | SPECIFIED TOLERANCES | <p align="center">STUDENT TYPIST CHAIR W/O WHEELS GRADE 7-12</p> <p align="center">X NO MEASUREMENTS TO BE SCALED FROM THE DRAWING</p> | <p align="center"><i>MOULDED POLYPROPYLENE, STEEL FRAME</i></p> | | | |
|-------|------|--------|--|---|--|--|--|--|
| | | |  | | | | | |
| | | | | | | | | |
| | | | | | | | | |
| | | | | | | | | |

TEACHER'S CHAIR

Note:

1. SEAT AND BACK APPROVED FOAM (SEAT MINIMUM 23KG) BACK MINIMUM 16KG) AND UPHOLSTERY (100% POLYPROPYLENE – CONTRACT QUALITY) FOAM TO BE GLUED ONTO 16MM PARTICLE BOARD
2. STACKABLE STEEL FRAME ASSEMBLY: 22.23X1.2MM SQUARE TUBING WITH BAKED BLACK EPOXY/POLYESTER POWDER COATING FINISH.
3. DURABLE PLUGS FITTED TO ALL OPEN STEEL ENDS
4. SEAT FITTED TO STEEL FRAME WITH APPROVED SCREWS
5. BACK FITTED WITH BOLTS & T-NUTS TO STEEL FRAME
6. CHAIR TO COMPLY WITH SANS/SABS 1244:1979

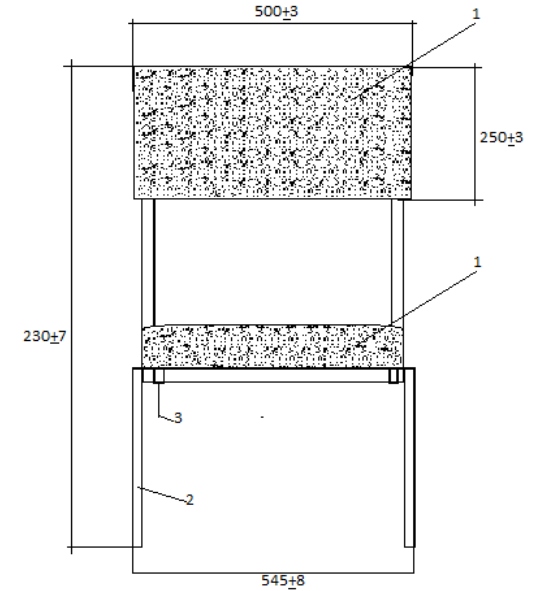
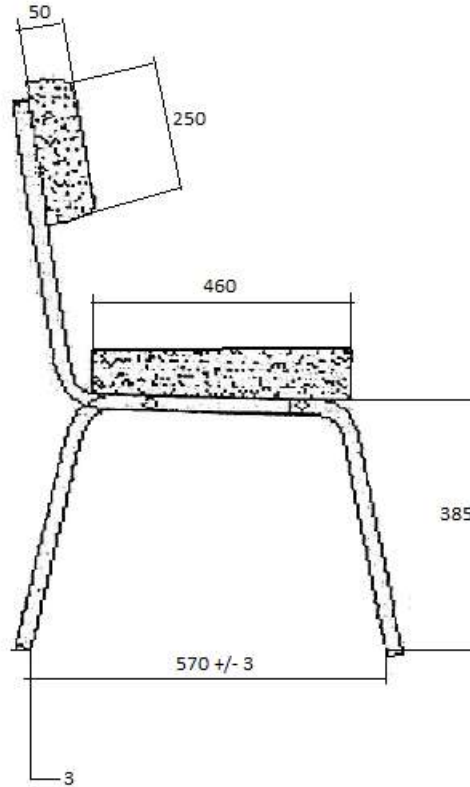



| ISSUE | DATE | CHANGE | SPECIFIED TOLERANCES | <p style="text-align: center;">TEACHER'S CHAIR</p> <p style="text-align: center;">X NO MEASUREMENTS TO BE SCALED FROM THE DRAWING</p> | <p style="text-align: center;">UPHOLSTERED CHAIR WITHOUT ARMS</p> | | | | | | | |
|-------|------|--------|--|--|--|--|--|--|--|--|--|--|
| | | |  | | | | | | | | | |
| | | | | | | | | | | | | |
| | | | | | | | | | | | | |
| | | | | | | | | | | | | |
| | | | | | | | | | | | | |

TEACHER'S OFFICE/STAFF ROOM DESK

Note:

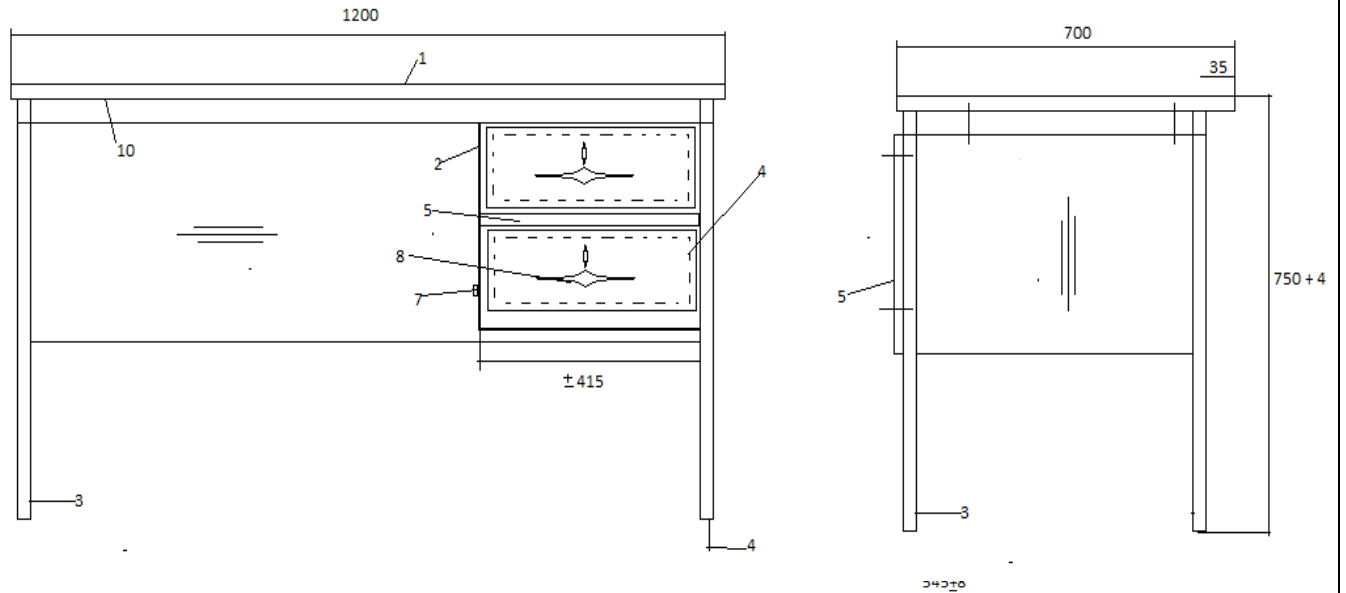
1. TABLE TOP – 21MM SOLID HARDWOOD,
2. MODESTY PANEL AND DRAWER BOX CARCASS MANUFACTURED FROM MATCHING 16MM SUBSTRATE VENEER BOARD ALL EDGES SEALED WITH MATCHING VEENER
3. 32X1.6MM SQUARE TUBING FRAME WITH BAKED BLACK EPOXY/POLYESTER POWDER COATING FINISH
4. DURABLE PLUGS FITTED TO ALL LEGS ENDS
5. 21MM SOLID SALIGNA HARDWOOD DRAWER FRONTS, TOP DRAWER LOCKABLE (APPROVED LOCK)
6. APPROVED HANDLE AND DRAWER SLIDES
7. KNOCK-DOWN "PRISMA" FITTING
8. MODESTY PANEL TO BE SECURED TO STEEL FRAME WITH 4.8X27MM LARGE FLANGE POP REVETS
9. ALL TIMBER COMPONENTS TO BE VARBISHED WITH TWO COATS OF ACD CATALYSED LACQUER
10. FIT TOP TO STEEL FRAME WITH APPROVED SCREWS
11. DESK MUST COMPLY WITH SABS 1528-2:1998 (EDITION 1.1)





| ISSUE | DATE | CHANGE | SPECIFIED TOLERANCES | TEACHER'S DESK | TEACHER'S DESK WITH 2 DRAWERS |
|-------|------|---|---|---|-------------------------------|
| | |  | FIGURE- +/- 1.2 FIGURE- +/- 1.2 FIGURE- +/- 1.2 | <p style="text-align: center;">TEACHER'S DESK</p> <p>X NO MEASUREMENTS TO BE SCALED FROM THE DRAWING</p> | |

TEACHER'S CLASSROOM DESK

Note:

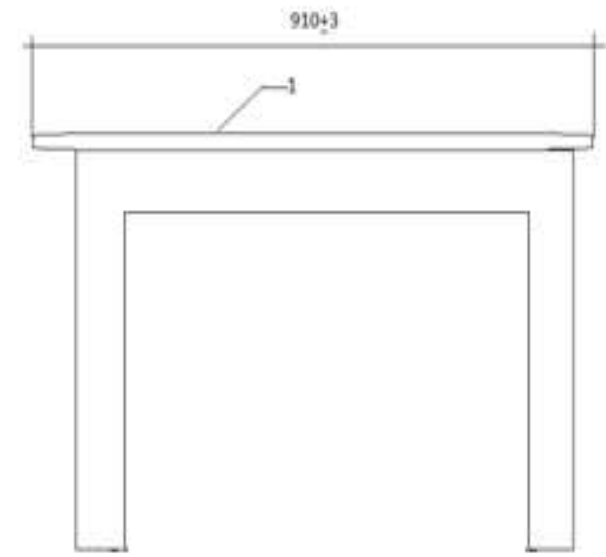
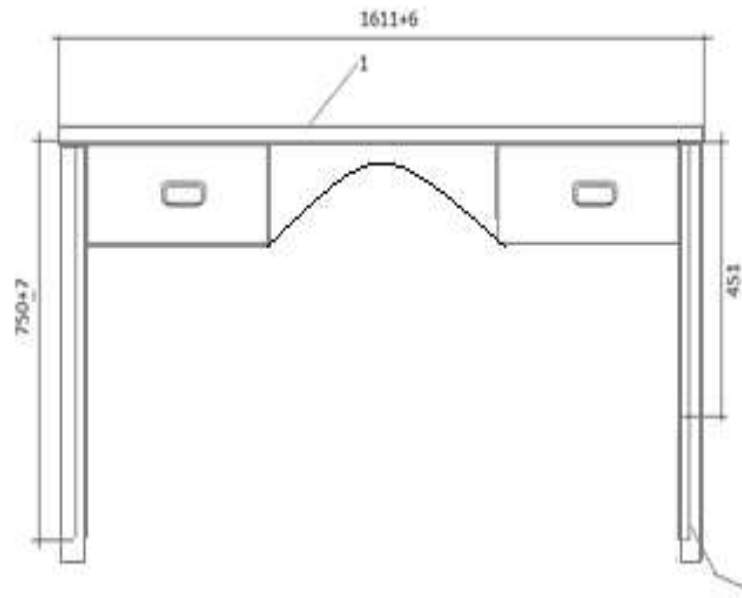
1. TABLE TOP – 21MM SOLID HARDWOOD,
2. DRAWERS MANUFACTURED FROM MATCHING 16MM SUBSTRATE VENEER BOARD ALL EDGES SEALED WITH MATCHING VENEER
3. 21MM SOLID SALIGNA HARDWOOD DRAWER FRONTS, BOTH DRAWERS LOCKABLE (APPROVED LOCK)
4. APPROVED HANDLE
5. KNOCK-DOWN “PRISMA” FITTING
6. ALL TIMBER COMPONENTS TO BE VARBISHED WITH TWO COATS OF ACD CATALYSED LACQUER
7. DESK MUST COMPLY WITH SABS 1528-2:1998 (EDITION 1.1)





| ISSUE | DATE | CHANGE | SPECIFIED TOLERANCES | TEACHER'S DESK | TEACHER'S DESK WITH 1 DRAWERSON BOTH SIDE |
|-------|------|---|---|---|---|
| | |  | FIGURE- +/- 1.2 FIGURE- +/- 1.2 FIGURE- +/- 1.2 | X NO MEASUREMENTS TO BE SCALED FROM THE DRAWING | |
| | | | | | |
| | | | | | |
| | | | | | |

STATIONERY CUPBOARD 2- DOOR/S - SHELVES

Note:

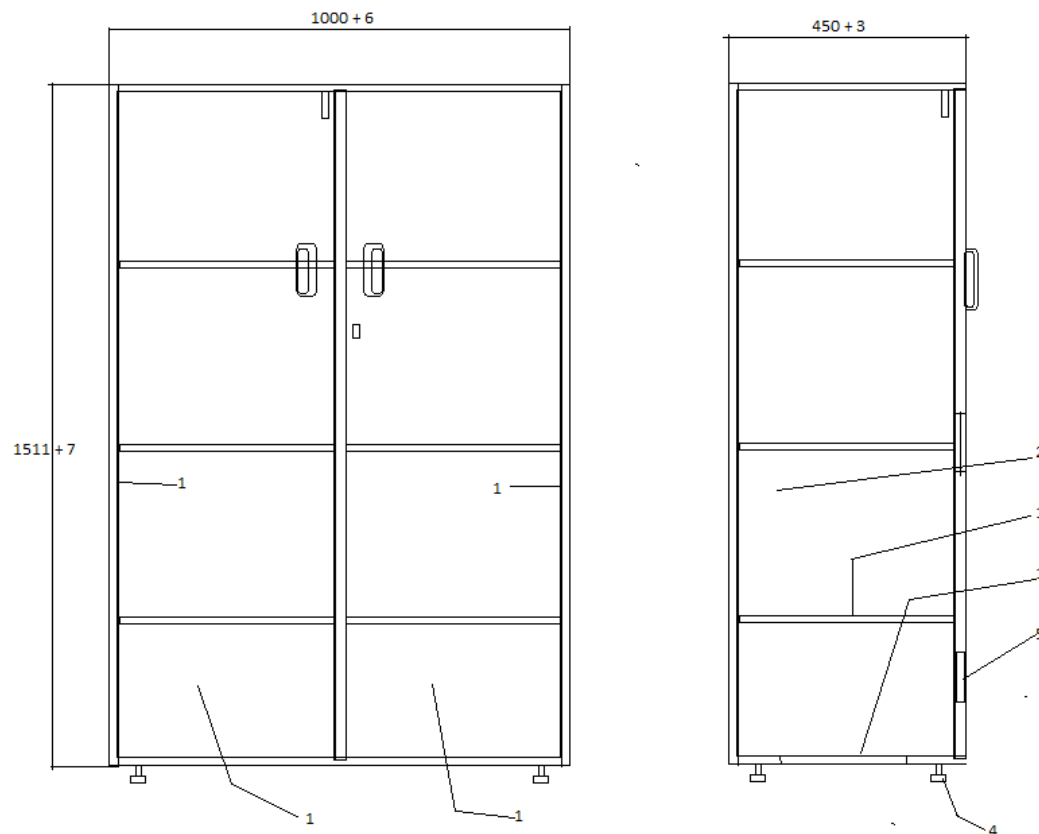
1. CARCASS (TOP, BOTTOM, DOORS, SIDES AND SHELVES) MANUFACTURING FROM 16MM DOUBLE MELAMINE FACED (NATURAL OAK) PARTICLE BOARD. ALL EDGES SEALED WITH MATCHING PVC EDGING.
2. BACK (GROOVED AND GLUED IN) MANUFACTURED FROM 12MM DOUBLE SIDED MELAMINE FACED (NATURAL OAK) PARTICLE BOARD
3. APPROVED SOLID OAK CUP HANDLE
4. APPROVED ADJUSTABLE FEET
5. APPROVED CONCEALED HINGES
6. CUPBOARD MUST COMPLY WITH SABS 1528-3:1992





| ISSUE | DATE | CHANGE | SPECIFIED TOLERANCES | <p style="text-align: center;">HEADS OF DEPT</p> <p style="text-align: center;"><i>STATIONERY CUPBOARD 2- DOOR/S - SHELVES</i></p> <p style="text-align: center;">X NO MEASUREMENTS TO BE SCALED FROM THE DRAWING</p> | |
|-------|------|---|---|--|--|
| | |  | <p>“FIGURE” = +/- 1.2 “FIGURE” = +/- 1.5 “FIGURE” = +/- 1.1</p> <p>UNSPECIFIED TOLERANCES = +/- 2.0</p> | | |

STATIONERY CUPBOARD 2- DOOR/S - SHELVES

Note:

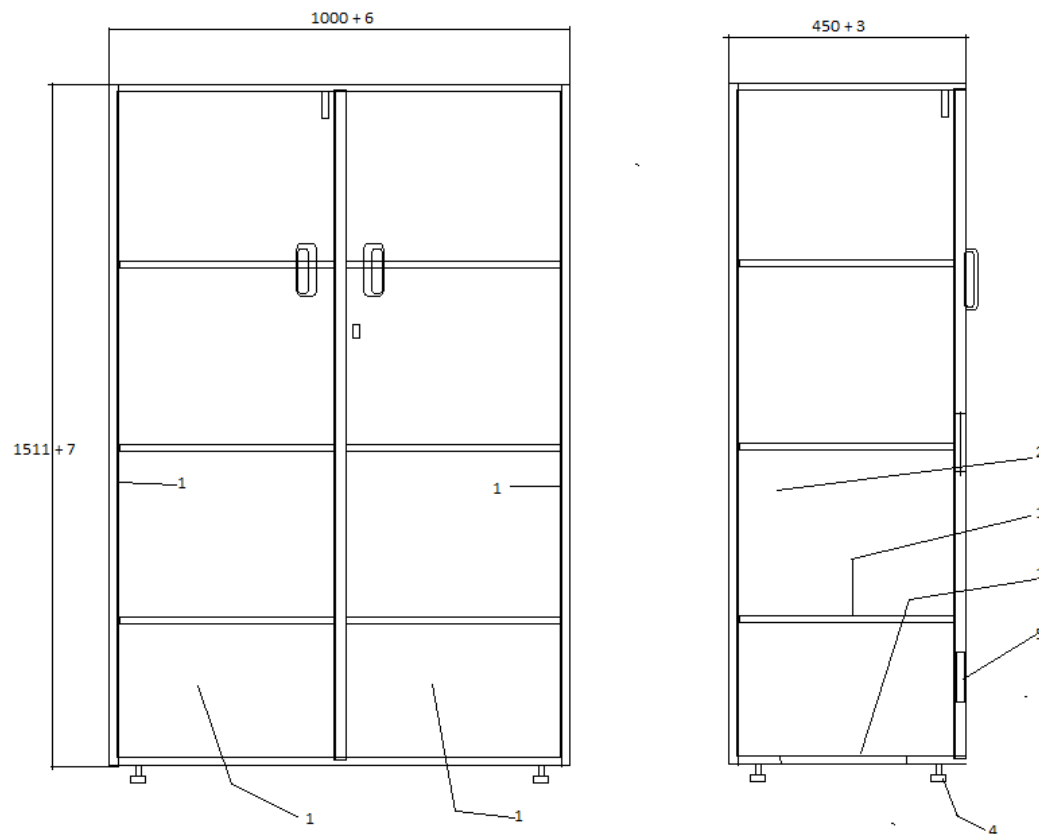
1. CARCASS (TOP, BOTTOM, DOORS, SIDES AND SHELVES) MANUFACTURING FROM 16MM DOUBLE MELAMINE FACED (NATURAL OAK) PARTICLE BOARD. ALL EDGES SEALED WITH MATCHING PVC EDGING.
2. BACK (GROOVED AND GLUED IN) MANUFACTURED FROM 12MM DOUBLE SIDED MELAMINE FACED (NATURAL OAK) PARTICLE BOARD
3. APPROVED SOLID OAK CUP HANDLE
4. APPROVED ADJUSTABLE FEET
5. APPROVED CONCEALED HINGES
6. CUPBOARD MUST COMPLY WITH SABS 1528-3:1992





| ISSUE | DATE | CHANGE | SPECIFIED TOLERANCES | PRINCIPALS | STATIONERY CUPBOARD 2- DOOR/S - SHELVES |
|-------|------|---|---|---|--|
| | |  | <p>“FIGURE” = +/- 1.2 “FIGURE” = +/- 1.5 “FIGURE” = +/- 1.1</p> <p>UNSPECIFIED TOLERANCES = +/- 2.0</p> | <p>X NO MEASUREMENTS TO BE SCALED FROM THE DRAWING</p> | |

STEEL FRAME SINGLE BED

Specification on the Mattress:

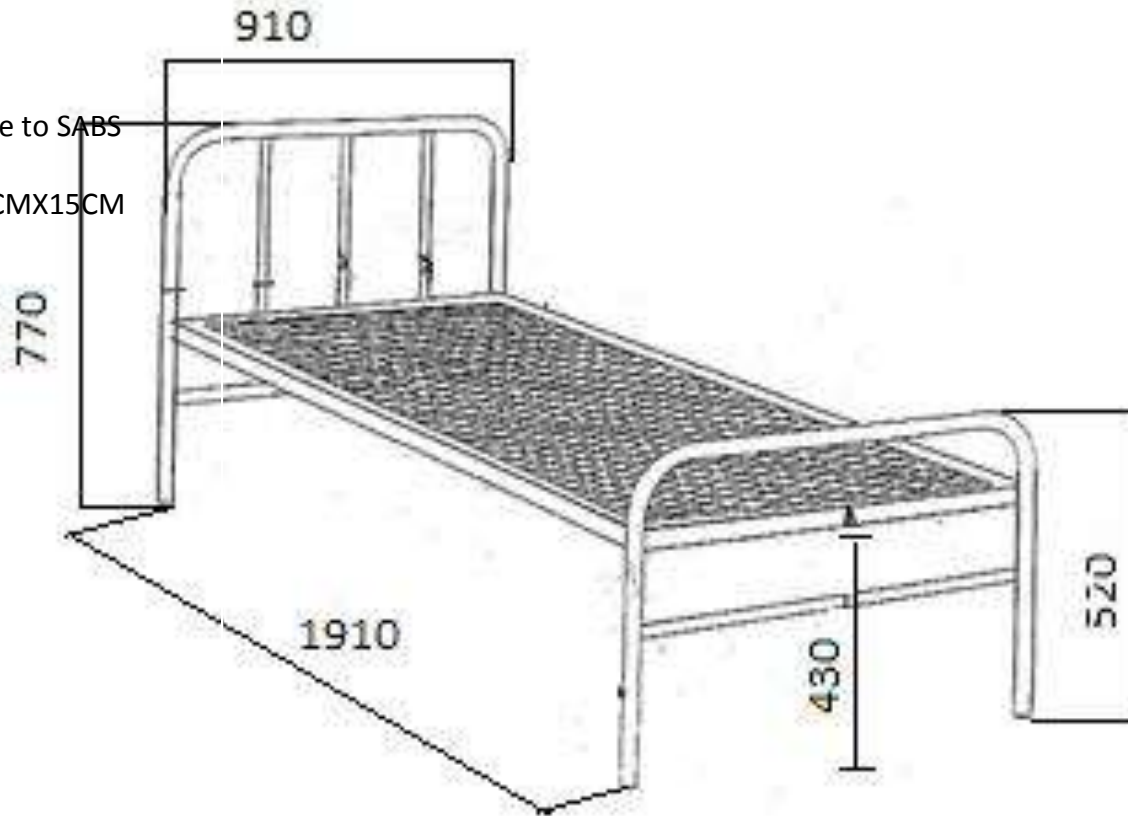
1. Plastic Foam sponge
2. Stitch-bond PVC Cover made to SABS standards.
3. Mattress Size – 191CMX91CMX15CM





| ISSUE | DATE | CHANGE | SPECIFIED TOLERANCES | <p>SINGLE BED</p> <p>X NO MEASUREMENTS TO BE SCALED FROM THE DRAWING</p> | <p>STEEL FRAME SINGLE BED</p> | | | |
|-------|------|---|----------------------|---|--------------------------------------|---|--------------------------------------|--|
| | |  | | | | <p>SINGLE BED</p> <p>X NO MEASUREMENTS TO BE SCALED FROM THE DRAWING</p> | <p>STEEL FRAME SINGLE BED</p> | |
| | | | | | | | | |
| | | | | | | | | |
| | | | | | | | | |
| | | | | | | | | |

PRINCIPAL CHAIR HIGH BACK

Note:

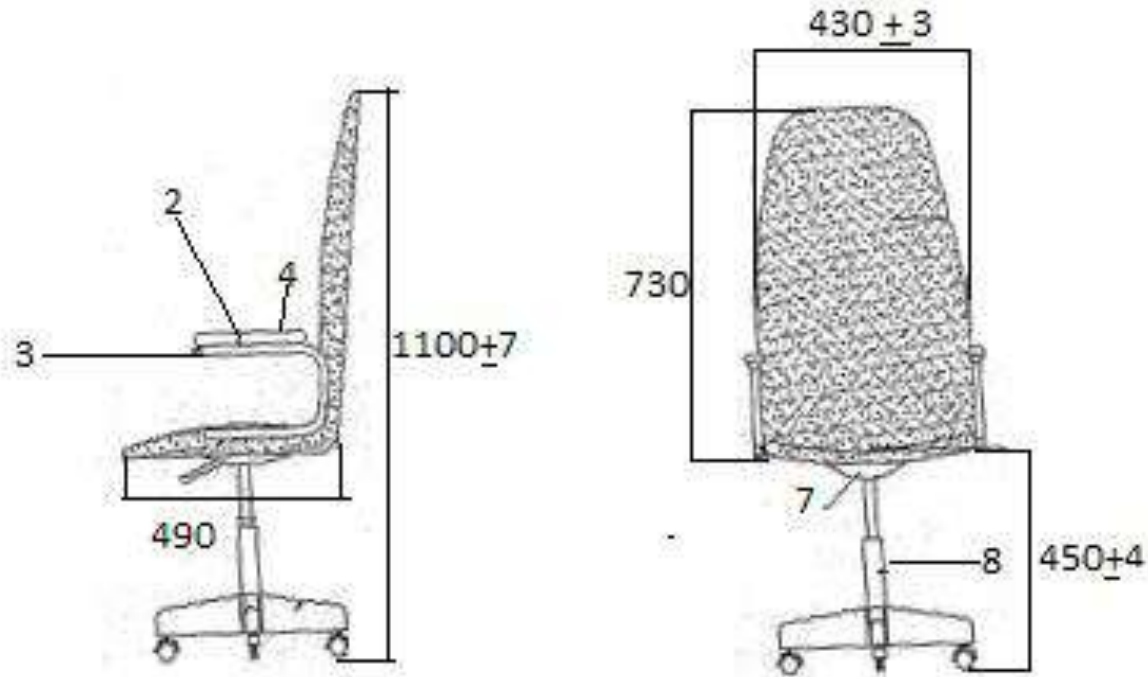
1. SEAT AND BACK APPROVED FOAM [SEAT (50MM THICK) MINIMUM] 23KG/M3; BACK(40MM THICK) MINIMUM 16KG/M3] AND UPHOLSTERY (100% POLYPROPYLENE – CONTRACT QUALITY) FOAM TO BE GLUED ONTO +/- 11MM SHAPED PLYWOOD SEAT AND BACK
2. STEEL FRAME; Ø25.4 X 1.6MM TUBING WITH BAKED BLACK EPOXY/POLYESTER POWDER COATING FINISH
3. DURABLE PLUGS FITTED TO ALL OPEN STEEL ENDS
4. APPROVED ARM RESTS TO BE FITTED TO STEEL FRAME
5. SEAT FITTED WITH BOLTS & T-NUTS TO STEEL FRAME
6. BACK FITTED WITH BOLTS & T-NUTS TO STEEL FRAME
7. SWIVEL & TILT MECHANISM
8. GAS HEIGHT ADJUSTABLE SPINDLE
9. FIVE (5) STAR REINFORCE NYLON BASE WITH DURABLE CASTORS
10. CHAIR TO COMPLY WITH SABS1528-1;1992





| ISSUE | DATE | CHANGE | SPECIFIED TOLERANCES | PRINCIPALS | HIGH BACK SWIVEL & TILT CHAIR WITH 5-STAR BASE |
|-------|------|---|--|---|--|
| | |  | "FIGURE" = +/- 1.2 "FIGURE" = +/- 1.5 "FIGURE" = +/- 1.1 UNSPECIFIED TOLERANCES = +/- 2.1 | X NO MEASUREMENTS TO BE SCALED FROM THE DRAWING | |
| | | | | | |
| | | | | | |
| | | | | | |

ADMINISTRATOR CHAIR TYPIST

Note:

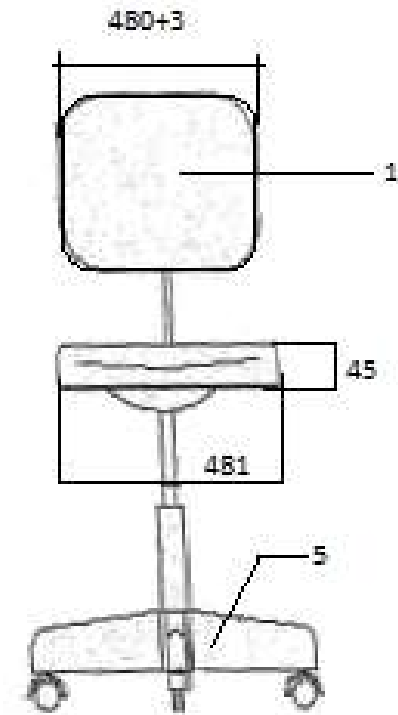
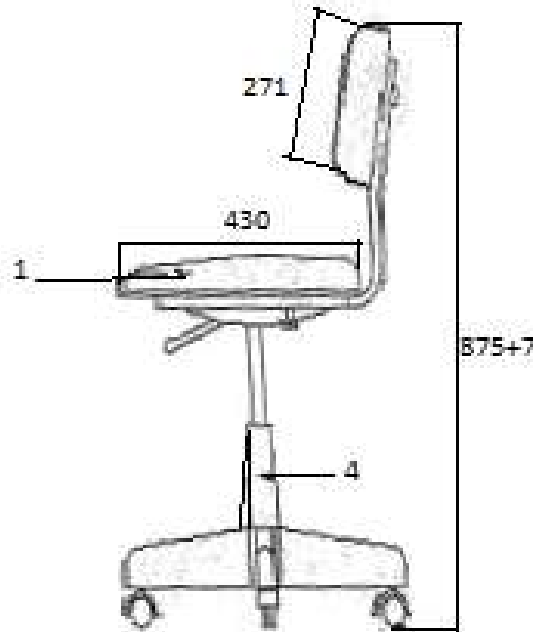
1. SEAT AND BACK APPROVED FOAM [SEAT (45MM THICK) MINIMUM 23KG/M3, BACK (25MM THICK) MINIMUM 16KG/M3] AND UPHOLSTERY (100% POLYPROPYLENE – CONTRACT QUALITY) FOAM TO BE GLUED ONTO ± 11MM SHAPED PLYWOOD SEAT AND BACK
2. SEAT FITTED WITH BOLTS & T-NUTS TO STEEL FRAME
3. BACK FITTED WITH BOLTS & T-NUTS TO STEEL FRMAE
4. GAS HEIGHT ADJUSTABLE SPINDLE
5. FIVE (5) STAR REINFORCE NYLON BASE WITH DURABLE CASTORS CHAIR TO COMPLY WITH SANS/SABS 1244;1979



| ISSUE | DATE | CHANGE | SPECIFIED TOLERANCES | ADMIN | LOWER BACK TYPIST CHAIR WITH 5-STAR BASE |
|-------|------|---|--|---|--|
| | |  | "FIGURE" = +/- 1.2 "FIGURE" = +/- 1.5 "FIGURE" = +/- 1.1 UNSPECIFIED TOLERANCES = +/- 2.1 | X NO MEASUREMENTS TO BE SCALED FROM THE DRAWING | |

FILLING RACK PIGEON HOLE 30 DIVISION

Note:

1. LP. LAMINATE: DOUBLE DECOR WITH 16mm SUBSTRATE (REF 2.1.9)
2. 6.4mm SHELVES AND 3.2mm BACK PANEL RECESSED INTO TOP AND SIDES (IN HARDBOARD)
3. ALL EPOSED EDGES TO BE EDGED WITH MATCHING LAMINATE (REF 2.1.3)

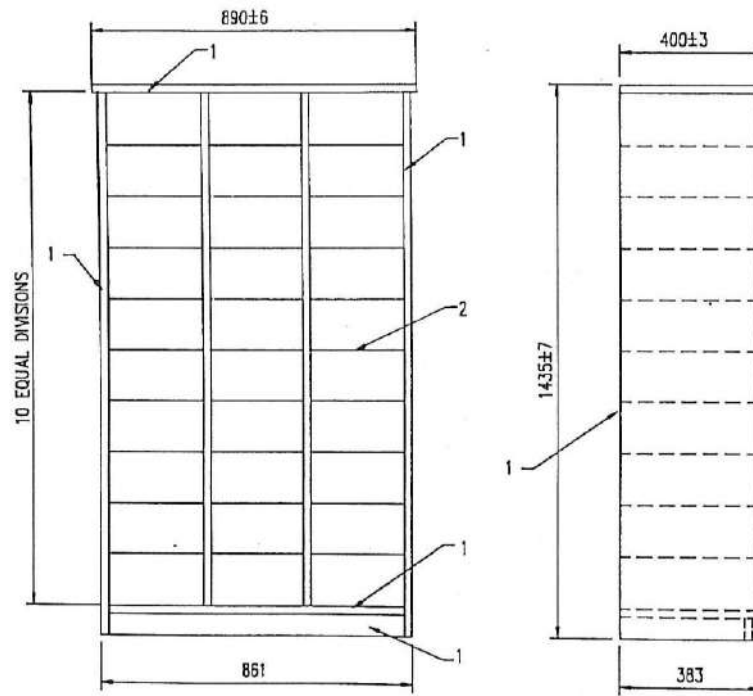



| ISSUE | DATE | CHANGE | SPECIFIED TOLERANCES | FILLING RACK | FILLING RACK PIGEON HOLE 30 DIVISION | |
|-------|------|--------|--|--|---|--|
| | | |  | <p>X NO MEASUREMENTS TO BE SCALED FROM THE DRAWING</p> | | |
| | | | | | | |
| | | | | | | |
| | | | | | | |

PRINCIPAL CORRESPONDENCE RACK

Note:

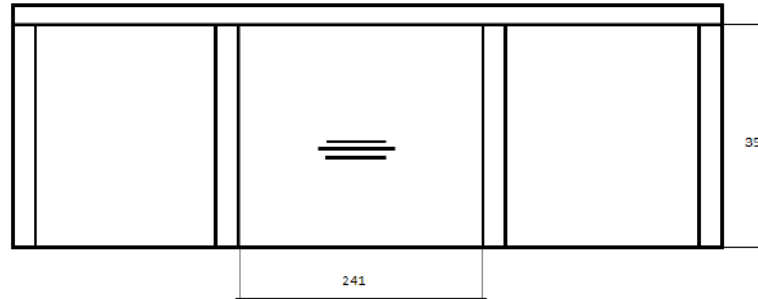
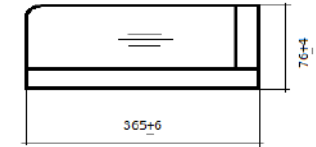
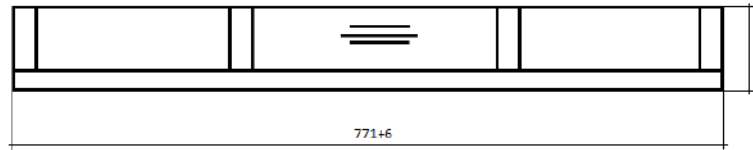
1. CARCASS (BOTTOM, SIDES, BACK AND DIVISION) MANUFACTURED FROM DOUBLE SIDED MELAMINE FACED (NATURAL OAK) 12MM PARTICLE BOARD
2. ALL EDGES SEALED WITH PVC EDGING
3. CORRESPONDENCE RACK MUST COMPLY WITH SABS 1528-3:1992





| ISSUE | DATE | CHANGE | SPECIFIED TOLERANCES | <p style="text-align: center;">PRINCIPAL CORR RACK</p> <p style="text-align: center;">X NO MEASUREMENTS TO BE SCALED FROM THE DRAWING</p> | <p style="text-align: center;"><i>CORRESPONDENCE RACK 3 DIVISION</i></p> | | | |
|-------|------|---|----------------------|--|---|--|---|--|
| | |  | | | | <p style="text-align: center;">PRINCIPAL CORR RACK</p> <p style="text-align: center;">X NO MEASUREMENTS TO BE SCALED FROM THE DRAWING</p> | <p style="text-align: center;"><i>CORRESPONDENCE RACK 3 DIVISION</i></p> | |
| | | | | | | | | |
| | | | | | | | | |
| | | | | | | | | |

PRINCIPAL GLASS BOOCKASE

Note:

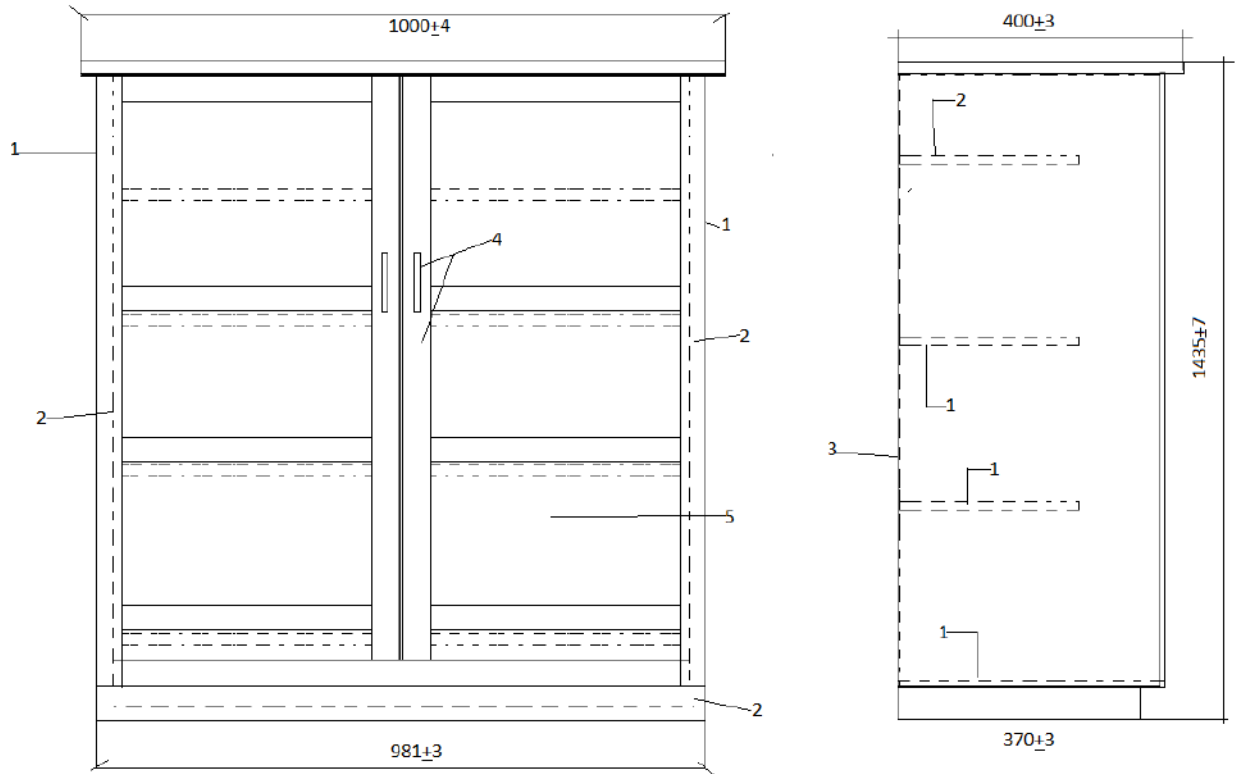
1. CARCASS (TOP,BOTTOM, SIDES AND ADJUSTABLE SHELVES) MANUFACTURED FROM 16MM SUBSTRATE VENEER BOARD (COLOUR TO MATCH ITEM IN FIG 13) ALL EDGES SEALED WITH MATCHING VENEER
2. DOOR FRAME ASSEMBLES, FIXED SHELF AND BASE MANUFACTURED FROM 21MM SOLID SALIGNA HARDWOOD (Eucalyptus Crendls)
3. BACK 3.2MM HARDBOARD
4. ALL TIMBER COMPONENTS TO BE VARNISHED WITH TWO COATS OF CATALYSED LACCUER
5. FIT 3MM CLEAR FLOAT GLASS TO DOOR FRAMES
6. BOOKCASE MUST COMPLY WITH SABS:1528-3:1992





| ISSUE | DATE | CHANGE | SPECIFIED TOLERENCES | PRINCIPAL BOOKCASE | WOODEN GLAZED DOOR BOOKCASE WITH 3 SHELVES |
|-------|------|--------|--|---|--|
| | | |  | X NO MEASUREMENTS TO BE SCALED FROM THE DRAWING | |

LIBRARY BOOKSHELF

Note:

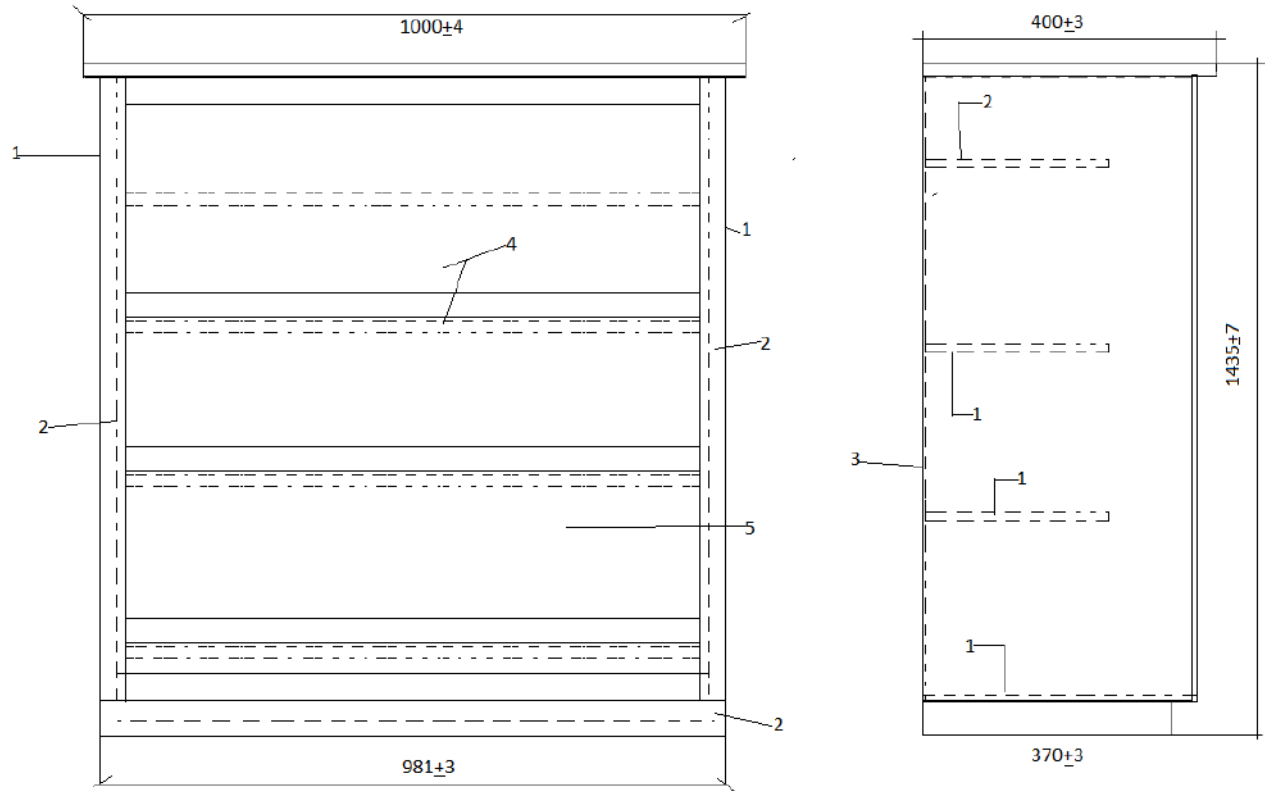
1. CARCASS (TOP,BOTTOM, SIDES AND ADJUSTABLE SHELVES) MANUFACTURED FROM 16MM SUBSTRATE VENEER BOARD (COLOUR TO MATCH ITEM IN FIG 13) ALL EDGES SEALED WITH MATCHING VENEER
2. DOOR FRAME ASSEMBLES, FIXED SHELF AND BASE MANUFACTURED FROM 21MM SOLID SALIGNA HARDWOOD (Eucalyptus Crendls)
3. BACK 3.2MM HARDBOARD
4. ALL TIMBER COMPONENTS TO BE VARNISHED WITH TWO COATS OF CATALYSED LACCUER
5. BOOKSHELF MUST COMPLY WITH SABS:1528-3:1992





| ISSUE | DATE | CHANGE | SPECIFIED TOLERANCES | <p style="text-align: center;">LIBRARY BOOKSHELF</p> <p style="text-align: center;">X NO MEASUREMENTS TO BE SCALED FROM THE DRAWING</p> | <p style="text-align: center;">WOODEN BOOKSHELF WITH 3 ADJUSTABLE SHELVES</p> | |
|-------|------|--------|---|--|--|--|
| | | |  | | | |

CORNER PIECE

Note:

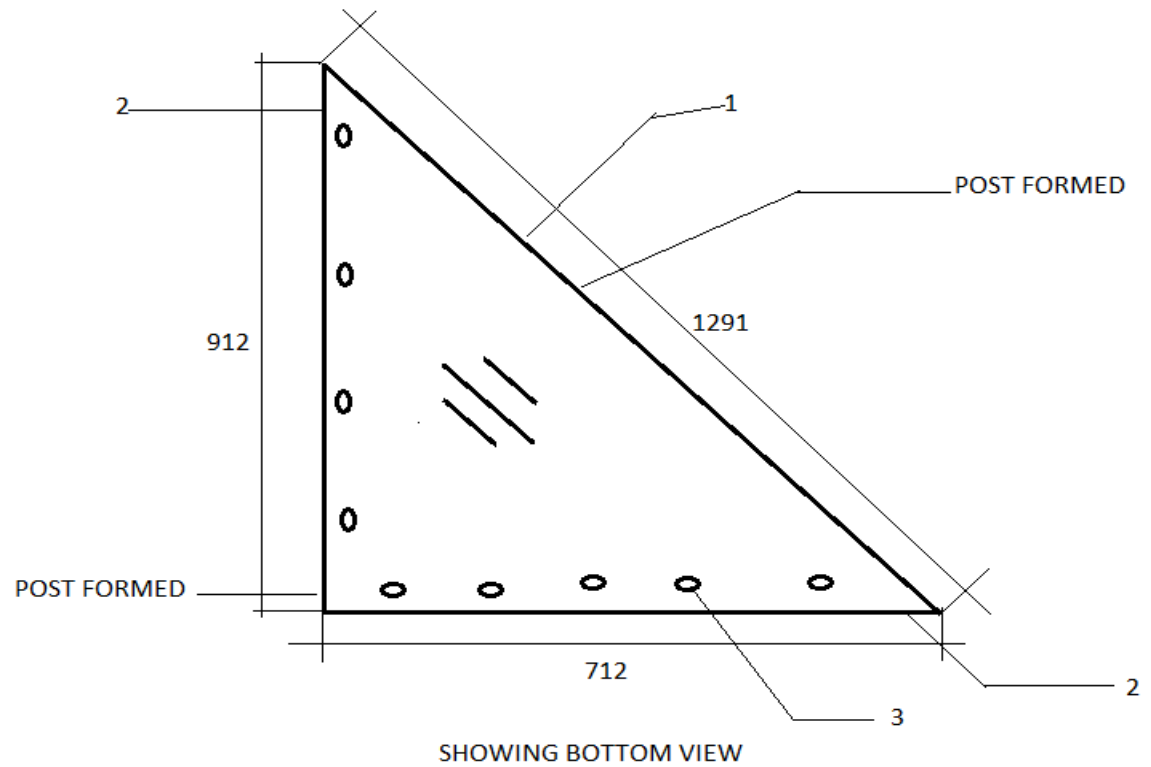
1. TOP POSTEDREWED (180°) DECORATIVE MELAMINE (COLOUR – NATURAL OAK) AND BALANCING BACKER LAMINATED ONTO A 32MM PARTICLE BOARD
2. EDGES TO BE SEALED WITH MATCHING PVC EDGING (AT LEAST 2MM THICK)
3. APPROVED FIXING METHOD TO DESK AND SIDE TABLES
4. CONNECTING CORNER MUST COMPLY WITH SABS 1528-2:1998 (Edition 1.1)





| ISSUE | DATE | CHANGE | SPECIFIED TOLERANCES | PRINCIPAL CONER PIECE | PRINCIPAL DESK CONNECTING CONER PIECE |
|-------|------|---|----------------------|--|---|
| | |  | | <p>PRINCIPAL CONER PIECE</p> <p>X NO MEASUREMENTS TO BE SCALED FROM THE DRAWING</p> | <p>PRINCIPAL DESK CONNECTING CONER PIECE</p> |
| | | | | | |
| | | | | | |
| | | | | | |

PRINCIPAL DESK

Note:

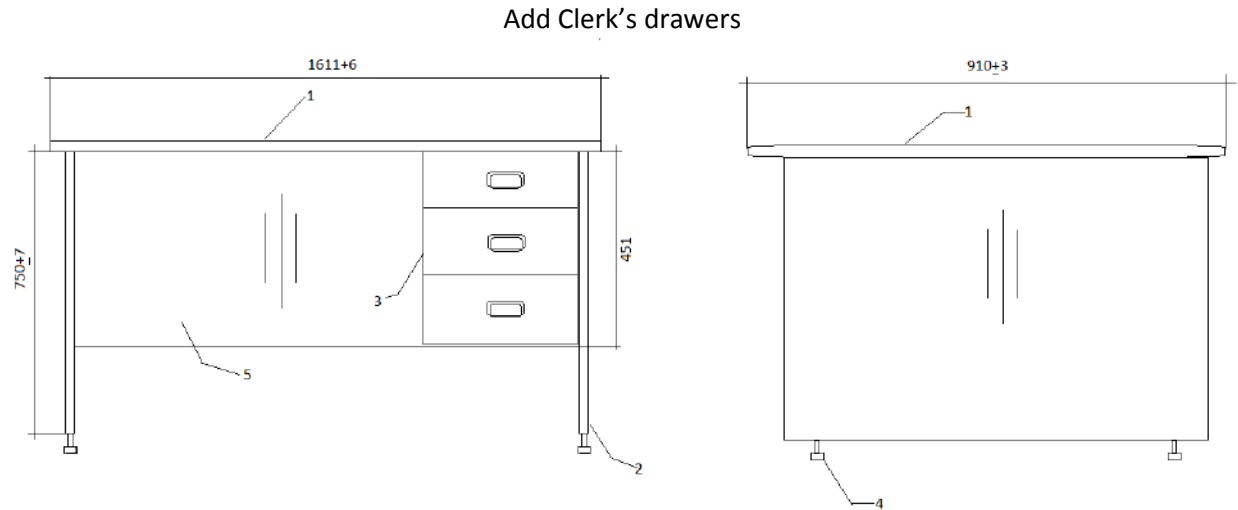
1. TOP POSTFORMED (180°) DECORATIVE MELAMINE (NATURAL OAK) WITH BALANCING BACKER LAMINATED ON 32MM SUBSTRATE PARTICLE BOARD.
2. SIDE PANELS SAME AS FOR TOP, BUT DOUBLE DECOR
3. DRAWER BOX WITH 3-DRAWERS TOP DRAWER LOCKABLE WITH PENCILTRAY APPROVED LOCK, METAL DRAWER RUNNERS AND MATCHING HANDLES
4. APPROVED HEIGHT ADJUSTABLE FEET
5. MODESTY PANEL, DOUBLE SIDED MELAMINE FACED (NATURAL OAK) 16MM PARTICLE BOARD
6. ALL EDGES SEALED WITH MATCHING PVC EDGING TOP EDGES EDGING AT LEAST 2MM THICK
7. DESK MUST COMPLY WITH SABS 1528-2.1996 (Edition 1.1)



| ISSUE | DATE | CHANGE | SPECIFIED TOLERANCES | | | |
|-------|------|---|----------------------|--|---|--|
| | |  | | PRINCIPAL DESK | <i>PRINCIPAL DESK WITH 3 DRAWERS FITTED ON RIGHT HAND SIDE</i> | |
| | | | | X NO MEASUREMENTS TO BE SCALED FROM THE DRAWING | | |

FILLING CABINET PRINCIPAL

Note:

1. TOP MELAMINE FACED (OAK) LAMINATE AND BALANCING BACKER LAMINATED TO A 32MM SUBSTRATE BOARD
2. CARCASS (SIDES, BOTTOM,RAILS AND DRAWER FRONTS) (NATURAL OAK) 16MM PARTICLE BOARD EDGES SEALED WITH MATCHING PVC EDGING TOP EDGES AT LEAST 2MM THICK PVC EDGING.
3. BACK MANUFACTURED FROM DOUBLE SIDED MELAMINE FACED (NATURAL OAK) 12MM PARTICLE BOARD
4. APPROVED LOCKS
5. DRAWER CARCASS MANUFACTURED FROM DOUBLE SIDED MELAMINE FACED 16MM PARTICLE BOARD, EDGES SEALED WITH MATCHING PVC EDGING, A4 POCKET FOLDERS MUST FIT IN DRAWER IN A HANGING POSITION
6. APPROVED HANDLE AND METAL DRAWER RUNNERS
7. CABINET MUST COMPLY WITH SABS 1528-3:1992

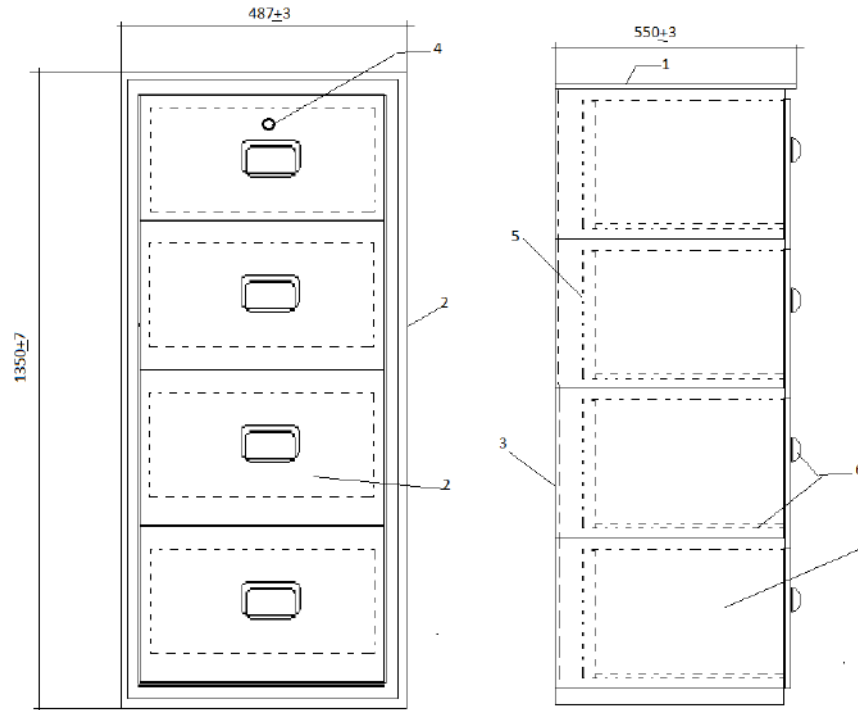



| ISSUE | DATE | CHANGE | SPECIFIED TOLERANCES | <p style="text-align: center;">PRINCIPAL FILING CABINET</p> <p style="text-align: center;">X NO MEASUREMENTS TO BE SCALED FROM THE DRAWING</p> | <p style="text-align: center;">FILLING CABINET 4 DRAWERS</p> |
|-------|------|--------|--|---|---|
| | | |  | | |

CREDENZA SLIDING DOORS - PRINCIPAL CREDENZA

Note:

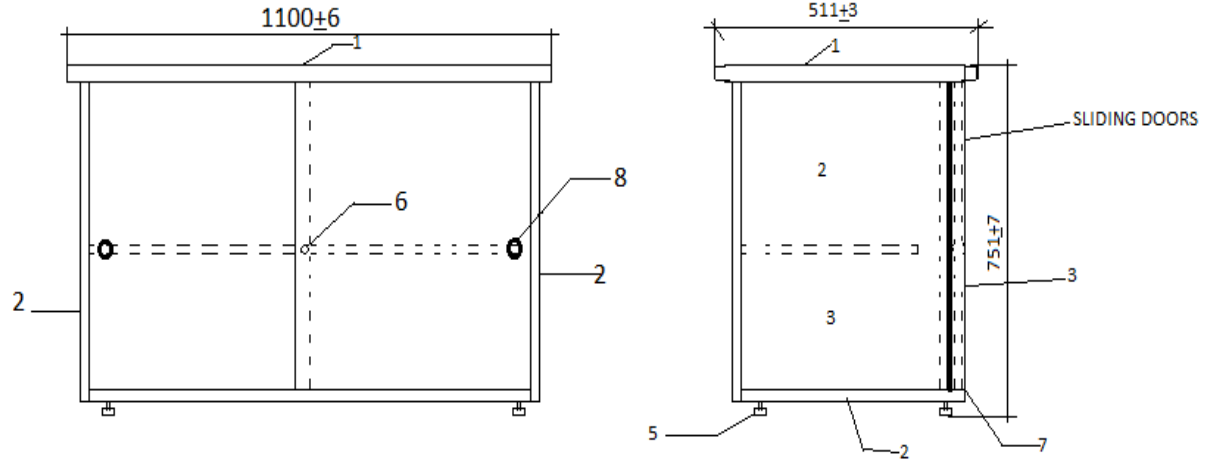
1. TOP POSTFORMED (180°) DECORATIVE MELAMINE OAK WITH BALANCED BACKER LAMINATED ON 32MM SUBSTRATE PARTICLE BOARD
2. CARCASS (SIDES, BOTTOM AND ADJUSTABLE SHELF) MANUFACTURED FROM 16MM DOUBLE SIDED MELAMINE FACED (NATURAL OAK) PARTICLE BOARD
3. DOORS AND BACK (GROOVED AND GLUED IN) MANUFACTURED FROM 12MM DOUBLE SIDED MELAMINE FACED (NATURAL OAK) PARTICLE BOARD
4. ALL EDGES TO BE SEALED WITH MATCHING PVC EDGING
5. APPROVED HEIGHT ADJUSTABLE FEET
6. APPROVED HANDLES AND LOCK (PUSH BUTTON)
7. PVC SLIDING HANDLES TOP AND BOTTOM
8. CREDENZA MUST COMPLY WITH SABS 1528-3:1992.



| ISSUE | DATE | CHANGE | SPECIFIED TOLERANCES | PRINCIPAL CREDENZA | CREDENZA WITH SLIDING DOORS |
|-------|------|---|----------------------|---|---|
| | |  | | <p>PRINCIPAL CREDENZA</p> <p>X NO MEASUREMENTS TO BE SCALED FROM THE DRAWING</p> | <p>CREDENZA WITH SLIDING DOORS</p> |
| | | | | | |
| | | | | | |
| | | | | | |

UPHOLSTERED CHAIR - HEAD OF DEPT

Note:

1. SEAT AND BACK APPROVED FOAM (SEAT MINIMUM 23KG/M3; BACK MINIMUM 16KG/M3) AND UPHOLSTERY (100% POLYPROPYLENE – CONTRACT QUALITY) FOAM TO BE GLUED ONTO 16MM PARTICLE BOARD
2. STACKABLE STEEL FRAME ASSEMBLY 22.23X1.2MM SQUARE TUBING WITH BAKED BLACK EPOXY/POLYESTER POWDER COATING FINISH
3. DURABLE PLUGS FITTED TO ALL OPEN STEEL ENDS
4. SEAT FITTED TO STEEL FRAME WITH APPROVED SCREWS
5. BACK FITTED WITH BOLTS & T-NUTS TO STEEL FRAME
6. APPROVED ARM RESTS FITTED TO STEEL FRAME
7. CHAIR TO COMPLY WITH SANS/SABS 1244:1979

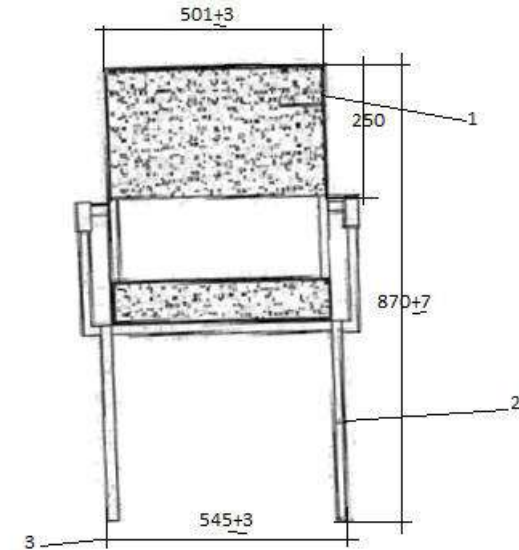
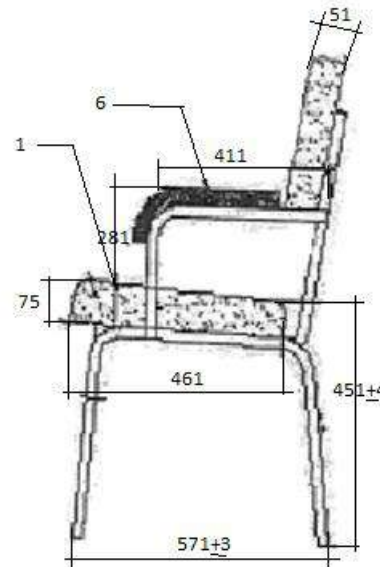

| ISSUE | DATE | CHANGE | SPECIFIED TOLERANCES | <p style="text-align: center;">HEAD OF DEPT</p> <p style="text-align: center;">X NO MEASUREMENTS TO BE SCALED FROM THE DRAWING</p> | <p style="text-align: center;">UPHOLSTERED SIDE CHAIR WITH ARMS</p> | |
|-------|------|--------|--|---|--|--|
| | | |  | | | |

UPHOLSTERED SICK ROOM CHAIR

Note:

1. SEAT AND BACK APPROVED FOAM (SEAT MINIMUM 23KG/M3; BACK MINIMUM 16KG/M3) AND UPHOLSTERY (100% POLYPROPYLENE – CONTRACT QUALITY) FOAM TO BE GLUED ONTO 16MM PARTICLE BOARD
2. STACKABLE STEEL FRAME ASSEMBLY 22.23X1.2MM SQUARE TUBING WITH BAKED BLACK EPOXY/POLYESTER POWDER COATING FINISH
3. DURABLE PLUGS FITTED TO ALL OPEN STEEL ENDS
4. SEAT FITTED TO STEEL FRAME WITH APPROVED SCREWS
5. BACK FITTED WITH BOLTS & T-NUTS TO STEEL FRAME
6. APPROVED ARM RESTS FITTED TO STEEL FRAME
7. CHAIR TO COMPLY WITH SANS/SABS 1244:1979

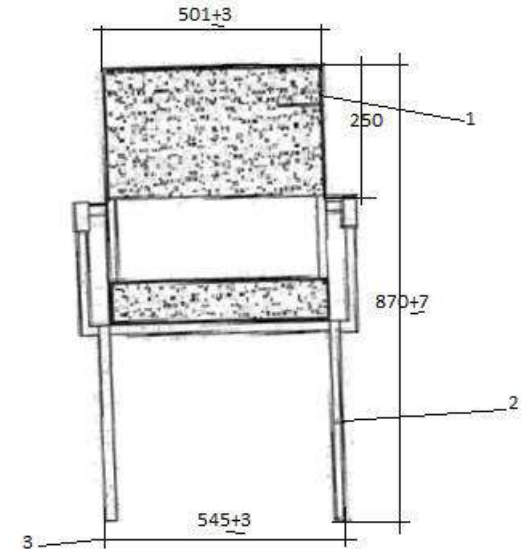
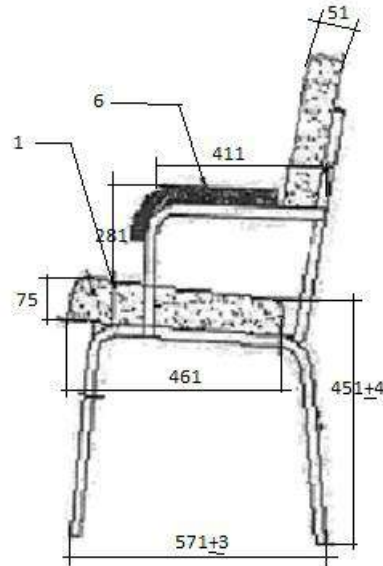

| ISSUE | DATE | CHANGE | SPECIFIED TOLERANCES | | | |
|-------|------|--------|--|--|--|--|
| | | |  | <p>SICK ROOM</p> <p>X NO MEASUREMENTS TO BE SCALED FROM THE DRAWING</p> | <p>UPHOLSTERED SIDE CHAIR WITH ARMS</p> | |